

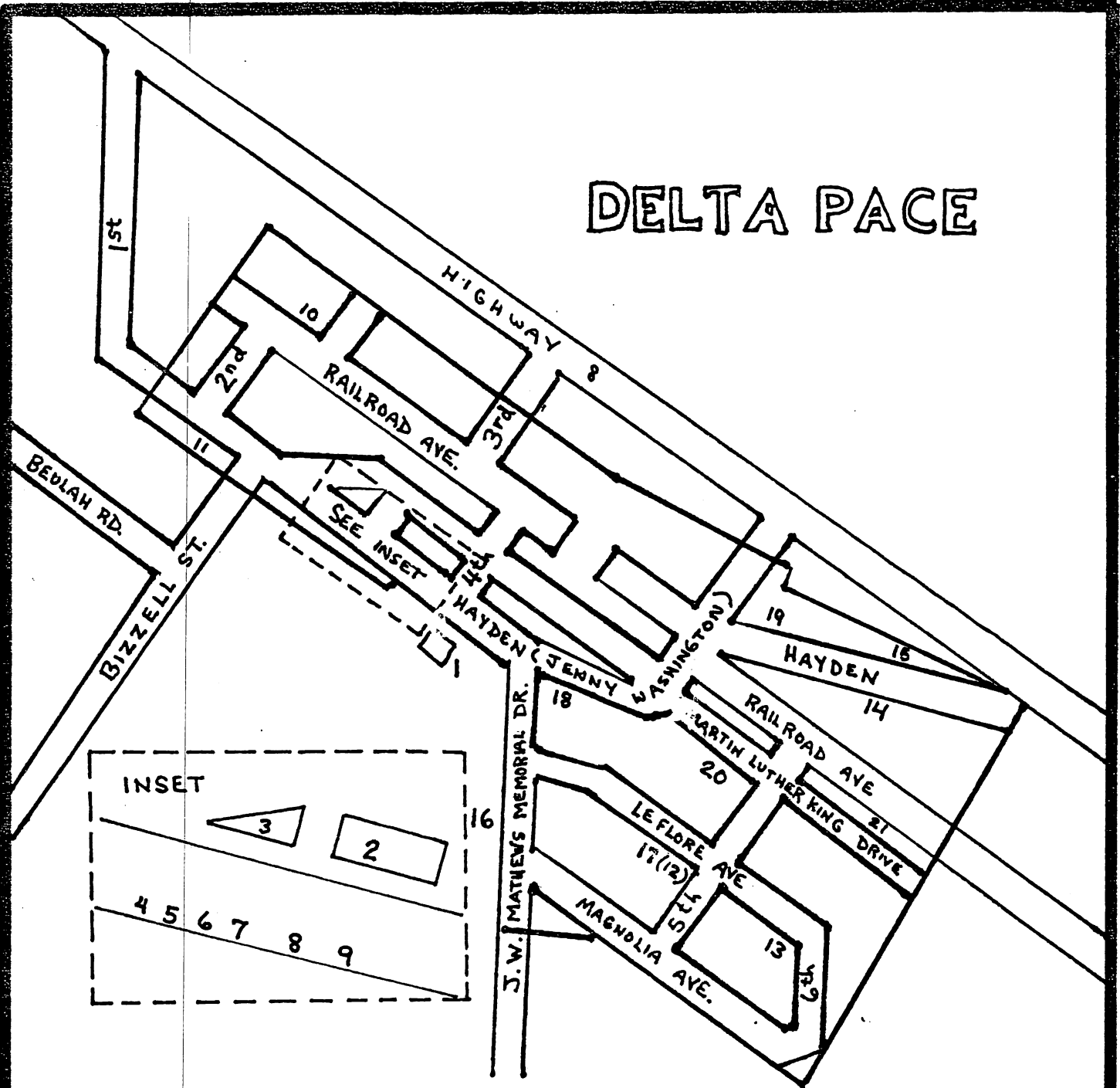

PACE

**HUMAN DEVELOPMENT
TRAINING SCHOOL**

DELTA PACE



- | | | |
|----------------------------|---|----------------------------|
| 1) ICA Office | 8) Laundromat | 15) St. Peter's Rock |
| 2) Town Hall | 9) Old Town Hall, Youth Dance Hall (Public Phone) | 16) Pace Attendance Center |
| 3) Post Office | 10) Baptist | 17) Headstart Buildings |
| 4) Lum's | 11) Methodist | 18) Restaurant (Blue Bldg) |
| 5) New Industry (Mr. Food) | 12) Spangle Banner | 19) Baseball field |
| 6) Commercial Building | 13) Pace Miracle Revival Center | 20) Elbethal Church |
| 7) Preschool | 14) St. Peter's M.B. | 21) Wats Chapel Church |

HUMAN DEVELOPMENT TRAINING SCHOOL CURRICULUM DESIGN

ECONOMIC DEVELOPMENT					SOCIAL DEVELOPMENT					CULTURAL DEVELOPMENT				
Week 1					Week 2					Week 3				
20th Century Perspectives					UR Images					Trends of the Future				
Economic	HERITAGE EXCURSION	WORK DAY	REFLECTION	meal	Social	URBAN EXCURSION	TOWN MEETING DAY	REFLECTION	meal	Cultural	ART EXCURSION	DOCUMENTATION	REFLECTION	
Round Table					Round Table					Round Table				
Cycle					Cycle					Cycle				
Leadership Methods	Imaginal Leadership Lab	celeb.			Workshop Methods	Community Forum Lab	celeb.			Motivation Methods	Profound Humanness Lab	celeb.		

7

June 1977

PROGRAMMATIC CHART



Toward the Actuation of Comprehensive Human Development Projects on the Local Level

thirty six programs – nine structures – three dynamics – one project

A ECONOMIC DEVELOPMENT LOCAL PRODUCTIVITY toward self sustenance	B HUMAN DEVELOPMENT LOCAL MOTIVITY -toward self-confidence	C SOCIAL DEVELOPMENT LOCAL SOCIALITY -toward self-reliance
Enabling local– COOPERATIVE AGRICULTURE 1 expanded cultivation 2 intensified production 3 water delivery 4 equipment pool	Reconstructing local– LIVING ENVIRONMENT 13 domestic housing 14 public facilities 15 village design 16 essential services	Creating local– PREVENTIVE CARE 25 intermediate sanitation 26 total nutrition 27 systematic immunization 28 primary treatment
Developing local– APPROPRIATE INDUSTRY 5 cottage production 6 agro-business 7 processing plants 8 ancillary industry	Catalyzing local– CORPORATE PATTERNS 17 total engagement 18 community commons 19 consensus assemblies 20 corporate workdays	Establishing local– FUNCTIONAL EDUCATION 29 early learning 30 formal schooling 31 youth training 32 adult education
Initiating local– COMMERCIAL SERVICES 9 common marketing 10 local merchandising 11 savings & loans 12 basic transport	Recovering local– IDENTITY SYSTEMS 21 community self-story 22 symbol systems 23 corporate rituals 24 village celebrations	Instituting local– COMMUNITY WELFARE 33 family development 34 women's advancement 35 youth task-force 36 elderly engagement

ECONOMIC, CULTURAL AND SOCIAL PRINCIPLES

ECONOMIC PRINCIPLES

1. Autonomous Unit
2. Monetary Input
3. Monetary Retention
4. Monetary Circulation
5. Global Relatedness

CULTURAL PRINCIPLES

1. Rapid expansion of consciousness
2. Expand interior space
3. Extend interior time
4. Diversify human relationships
5. Expansion of corporate engagement

SOCIAL PRINCIPLES

1. Delimited Geography
2. All Problems
3. All People
4. Depth Issue
5. Symbol is Key

PACE
HDTS

DAILY TIME DESIGN

June 1 - 23, 1980

	DISCIPLINE	TIME	EVENT
MORNING	WAKEUP	6:00 a.m.	Wakeup rite, rising and preparing for the day
	BREAKFAST	6:30 a.m.	Opening Ritual Breakfast/Collegium
		8:00 a.m.	Individual/Space Care
	MODULE/ LABORATORY	8:30 a.m.	Contextual Talk and Interchange
		9:30 a.m.	Snack
		9:30 a.m.	Field Session/Lab Workshop
		11:30 a.m.	Interlude
AFTERNOON	DINNER/ ROUNDTABLE	12:00 noon	Dinner Conversation/Study
		1:30 p.m.	Break
	MODULE/ LABORATORY	3:30 p.m.	Field Session/Lab Workshop
		6:00 p.m.	Preparation for dinner
EVENING	SUPPER	7:00 p.m.	Leadership Methods Dinner/Methods Use/ Evaluation
		8:30 p.m.	Informal Conversation
	PHYSICAL RESTORATION	10:00 p.m.	Sleep

The Daily Ritual

CREATION

ENTRY (Verses 1 and 2)

A time to set forth a new demand,
A time to look into the past,
For without "what has been," there is no "yet to be,"
Nothing that we do then could last.

Refrain

We stand beyond our life and see,
We stand beyond our death and really see,
What's required of those who give their death to history,
And it is now that we must do
What other ones have always longed to see,
To discover what's required
To set all people free.

No more must we live with poverty,
No more in strife and disarray,
For when Those Who Care create all the earth,
That shall be the new day.

EXIT (Verses 3 and 4)

In those who choose to be all there is
Pain and misery are past,
Transformed because they bring forth human life;
New life never comes but through a death.

Refrain

The global task now has claimed our lives,
Who knows where our bodies they shall find?
But with us, anew, now the mystery appears,
The meaning of the life of all Mankind.

Refrain

(Let the Community stand and sing first two verses of the song,
"Creation")

Leader: Let us stand before life as those who care
for the world.

Community: Be it so.

ACT I: **L:** Life is never the way we want it.
C: We refuse to accept its promise.
L: Nevertheless we are free to live.
C: Be it so.

(Let the community be seated)

Reading for the Day

(Let the community stand)

ACT II: **L:** This is the day we have on our hands.
C: We give thanks for the life we have.
L: This is our decision.
C: Be it so.

L: Let all the joy mingle in my last song.

Community Left: The joy that makes the earth flow
over in riotous excess.

Community Right: The joy that sets the twin brothers, life
and death dancing,

Community Left: The joy that sweeps in the tempest,
waking all life with laughter,

Community Right: The joy that throws everything it has
upon the dust.

(Let the community be seated)

Address for the Day

(Let the community stand)

ACT III: **L:** We stand before the world and its need.
C: Let us give ourselves to the task.
L: It is to build the Earth.
C: Be it so.

L: Let me not pray to be sheltered from dangers,

C: But to be fearless in facing them.

L: Let me not beg for the stilling of my pain,

C: But for the heart to conquer it.

L: Let me not look for allies in life's battlefield,

C: But to my own strength.

L: Let me not crave, in anxious fear to be saved,

C: But hope for the patience to win my freedom.

Leader: Let us go forth to enact our care for the world.

Community: Be it so.

(Let the community sing last two
verses of the song, "Creation")

BREAKFAST

(Repeat after me)

- At the edge of history
- The Future is blowing wildly in our faces
- Sometimes brightening the air
- And sometimes blinding us.

DINNER

(Repeat after me)

- The Task before us now
- If we would not perish
- Is to shake off our ancient prejudices
- And to build the earth.

SUPPER

(Repeat after me)

- Action will remove the doubt
- That theory cannot solve.

CLOSING

Leader: These are the times,

Community: We are the people.

(Repeat) :

PACE HDTS

FACILITIES

JUNE, 1980

PACE ATTENDANCE CENTER

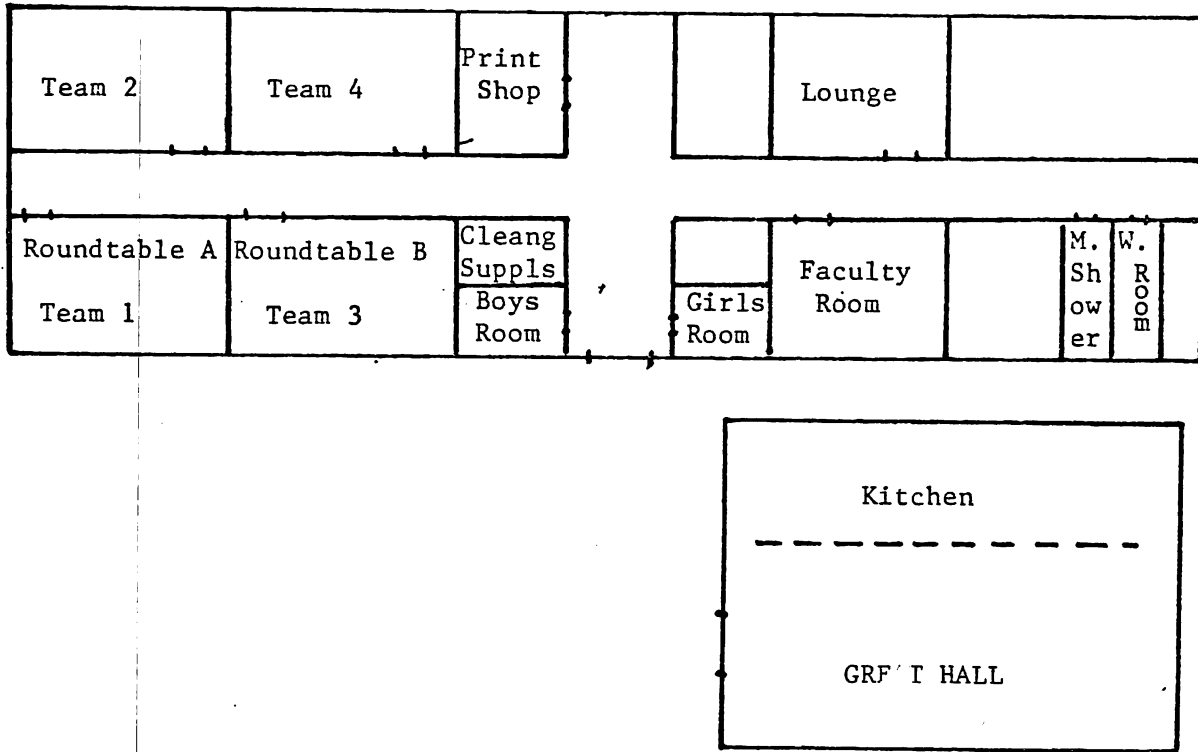

← to Mathews Memorial Dr.
and Attendance Center

LEFLORE AVE.

Drive-way

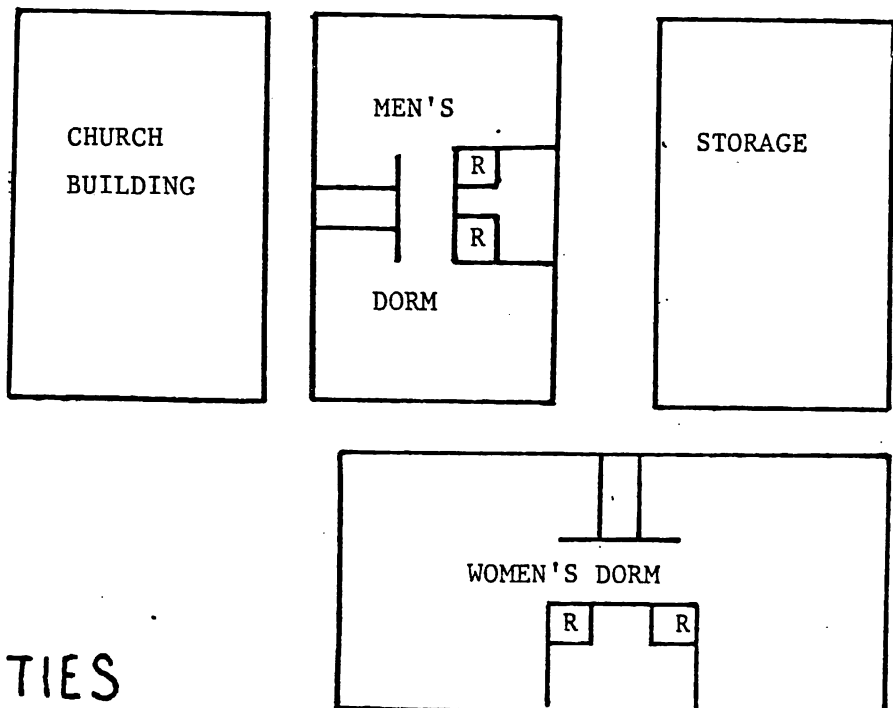

RESIDENTIAL FACILITIES



PACE

**HUMAN DEVELOPMENT
TRAINING SCHOOL**

DELTA PACE

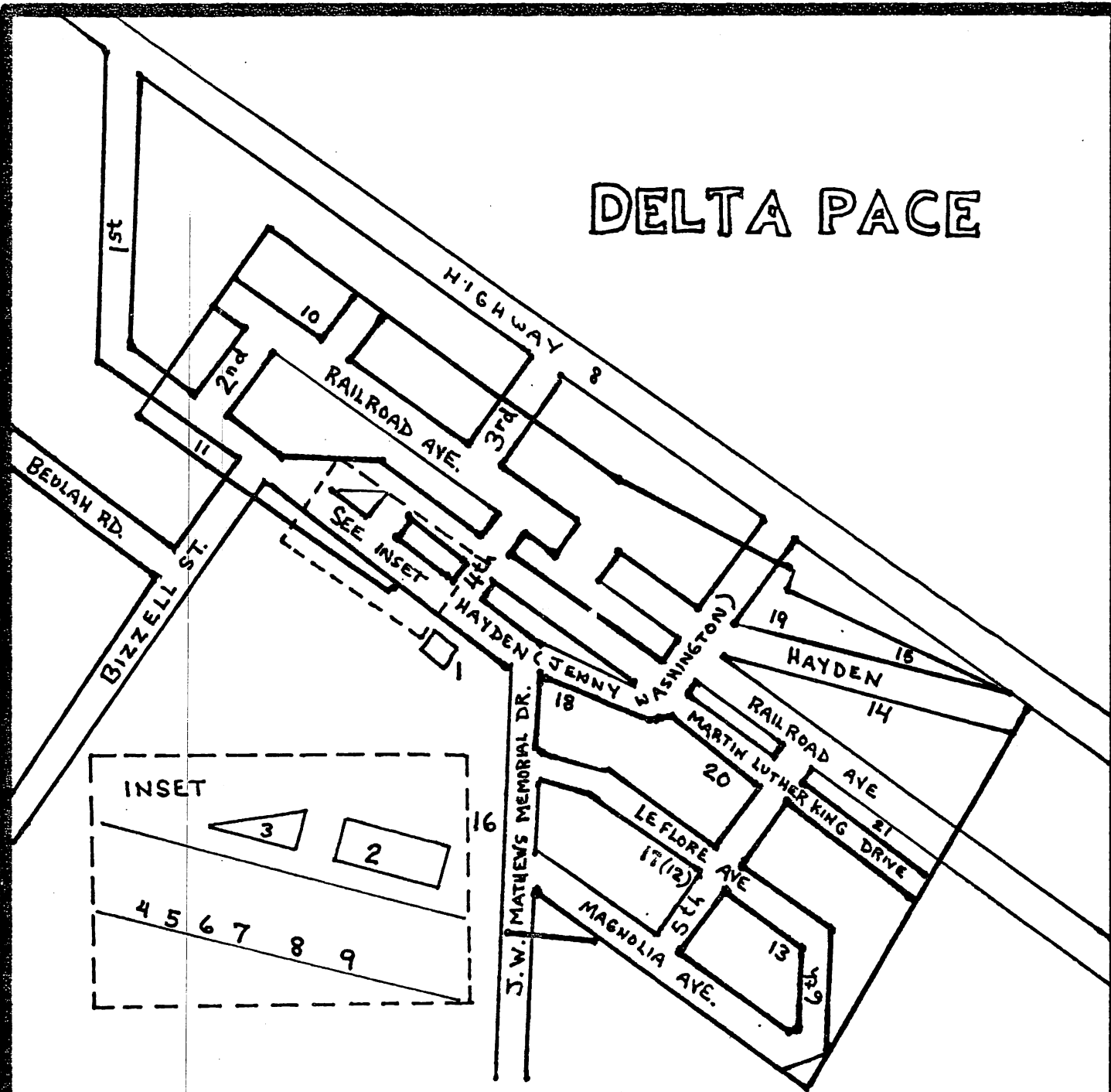

- | | | |
|----------------------------|---------------------------------|----------------------------|
| 1) ICA Office | 8) Laundromat | 15) St. Peter's Rock |
| 2) Town Hall | 9) Old Town Hall, Youth Dance | 16) Pace Attendance Center |
| 3) Post Office | Hall (Public Phone) | |
| 4) Lum's | 10) Baptist | 17) Headstart Buildings |
| 5) New Industry (Mr. Food) | 11) Methodist | 18) Restaurant (Blue Bldg) |
| 6) Commercial Building | 12) Spangle Banner | 19) Baseball field |
| 7) Preschool | 13) Pace Miracle Revival Center | 20) Elbethal Church |
| | 14) St. Peter's M.B. | 21) Wats Chapel Church |

HUMAN DEVELOPMENT TRAINING SCHOOL CURRICULUM DESIGN

ECONOMIC DEVELOPMENT				SOCIAL DEVELOPMENT				CULTURAL DEVELOPMENT			
Week 1				Week 2				Week 3			
20th Century Perspectives				UR Images				Trends of the Future			
Economic	HERITAGE EXCURSION	WORK DAY	REFLECTION Meal	Social	URBAN EXCURSION	TOWN MEETING DAY	REFLECTION Meal	Cultural	ART EXCURSION	DOCUMENTATION	REFLECTION
Round Table				Round Table				Round Table			
Cycle				Cycle				Cycle			
Leadership Methods	Imaginal Leadership Lab	celebr.		Workshop Methods	Community Forum Lab	celebr.		Motivation Methods	Profound Humanness Lab	celebr.	

4

June 1977

PROGRAMMATIC CHART



Toward the Actuation of Comprehensive Human Development Projects on the Local Level

thirty six programs – nine structures – three dynamics – one project

A ECONOMIC DEVELOPMENT LOCAL PRODUCTIVITY toward self sustenance	B HUMAN DEVELOPMENT LOCAL MOTIVITY -toward self-confidence	C SOCIAL DEVELOPMENT LOCAL SOCIALITY -toward self-reliance
Enabling local— COOPERATIVE AGRICULTURE 1 expanded cultivation 2 intensified production 3 water delivery 4 equipment pool	Reconstructing local— LIVING ENVIRONMENT 13 domestic housing 14 public facilities 15 village design 16 essential services	Creating local— PREVENTIVE CARE 25 intermediate sanitation 26 total nutrition 27 systematic immunization 28 primary treatment
Developing local— APPROPRIATE INDUSTRY 5 cottage production 6 agro-business 7 processing plants 8 ancillary industry	Catalyzing local— CORPORATE PATTERNS 17 total engagement 18 community commons 19 consensus assemblies 20 corporate workdays	Establishing local— FUNCTIONAL EDUCATION 29 early learning 30 formal schooling 31 youth training 32 adult education
Initiating local— COMMERCIAL SERVICES 9 common marketing 10 local merchandising 11 savings & loans 12 basic transport	Recovering local— IDENTITY SYSTEMS 21 community self-story 22 symbol systems 23 corporate rituals 24 village celebrations	Instituting local— COMMUNITY WELFARE 33 family development 34 women's advancement 35 youth task-force 36 elderly engagement

ECONOMIC, CULTURAL AND SOCIAL PRINCIPLES

ECONOMIC PRINCIPLES

1. Autonomous Unit
2. Monetary Input
3. Monetary Retention
4. Monetary Circulation
5. Global Relatedness

CULTURAL PRINCIPLES

1. Rapid expansion of consciousness
2. Expand interior space
3. Extend interior time
4. Diversify human relationships
5. Expansion of corporate engagement

SOCIAL PRINCIPLES

1. Delimited Geography
2. All Problems
3. All People
4. Depth Issue
5. Symbol is Key

PACE

DAILY TIME DESIGN

June 1 - 23, 1980

HDTS

	DISCIPLINE	TIME	EVENT
MORNING	WAKEUP	6:00 a.m.	Wakeup rite, rising and preparing for the day
	BREAKFAST	6:30 a.m.	Opening Ritual Breakfast/Collegium
		8:00 a.m.	Individual/Space Care
	MODULE/ LABORATORY	8:30 a.m.	Contextual Talk and Interchange
		9:30 a.m.	Snack
		9:30 a.m.	Field Session/Lab Workshop
		11:30 a.m.	Interlude
AFTERNOON	DINNER/ ROUNDTABLE	12:00 noon	Dinner Conversation/Study
		1:30 p.m.	Break
	MODULE/ LABORATORY	3:30 p.m.	Field Session/Lab Workshop
		6:00 p.m.	Preparation for dinner
EVENING	SUPPER	7:00 p.m.	Leadership Methods Dinner/Methods Use/ Evaluation
		8:30 p.m.	Informal Conversation
	PHYSICAL RESTORATION	10:00 p.m.	Sleep

The Daily Ritual

(Let the Community stand and sing first two verses of the song, "Creation")

CREATION

ENTRY (Verses 1 and 2)

A time to set forth a new demand,
A time to look into the past,
For without "what has been," there is no "yet to be;"
Nothing that we do then could last.

Refrain:

We stand beyond our life and see,
We stand beyond our death and really see,
What's required of those who give their death to history;
And it is now that we must do
What other ones have always longed to see,
To discover what's required
To set all people free.

No more must we live with poverty,
No more in strife and disarray,
For when Those Who Care create all the earth,
That shall be the new day.

EXIT (Verses 3 and 4)

In those who choose to be all there is
Pain and misery are past,
Transformed because they bring forth human life;
New life never comes but through a death.

Refrain:

The global task now has claimed our lives,
Who knows where our bodies they shall find?
But with us, anew, now the mystery appears,
The meaning of the life of all Mankind.

Refrain:

Leader: Let us stand before life as those who care
for the world.

Community: Be it so.

ACT I: **L:** Life is never the way we want it.
C: We refuse to accept its promise.
L: Nevertheless we are free to live.
C: Be it so.

(Let the community be seated)

Reading for the Day

(Let the community stand)

ACT II: **L:** This is the day we have on our hands.
C: We give thanks for the life we have.
L: This is our decision.
C: Be it so.

L: Let all the joy mingle in my last song.

Community Left: The joy that makes the earth flow
over in riotous excess.

Community Right: The joy that sets the twin brothers, life
and death dancing,

Community Left: The joy that sweeps in the tempest,
waking all life with laughter,

Community Right: The joy that throws everything it has
upon the dust.

(Let the community be seated)

Address for the Day

(Let the community stand)

ACT III: **L:** We stand before the world and its need.
C: Let us give ourselves to the task.
L: It is to build the Earth.
C: Be it so.

L: Let me not pray to be sheltered from dangers,

C: But to be fearless in facing them.

L: Let me not beg for the stilling of my pain,

C: But for the heart to conquer it.

L: Let me not look for allies in life's battlefield,

C: But to my own strength.

L: Let me not crave, in anxious fear to be saved,

C: But hope for the patience to win my freedom.

Leader: Let us go forth to enact our care for the world.

Community: Be it so.

(Let the community sing last two
verses of the song, "Creation")

BREAKFAST

(Repeat after me)

- At the edge of history
- The Future is blowing wildly in our faces
- Sometimes brightening the air
- And sometimes blinding us.

DINNER

(Repeat after me)

- The Task before us now
- If we would not perish
- Is to shake off our ancient prejudices
- And to build the earth.

SUPPER

(Repeat after me)

- Action will remove the doubt
- That theory cannot solve.

CLOSING

Leader: These are the times,

Community: We are the people.

(Repeat)

PACE HDTS

FACILITIES

JUNE, 1980

PACE ATTENDANCE CENTER

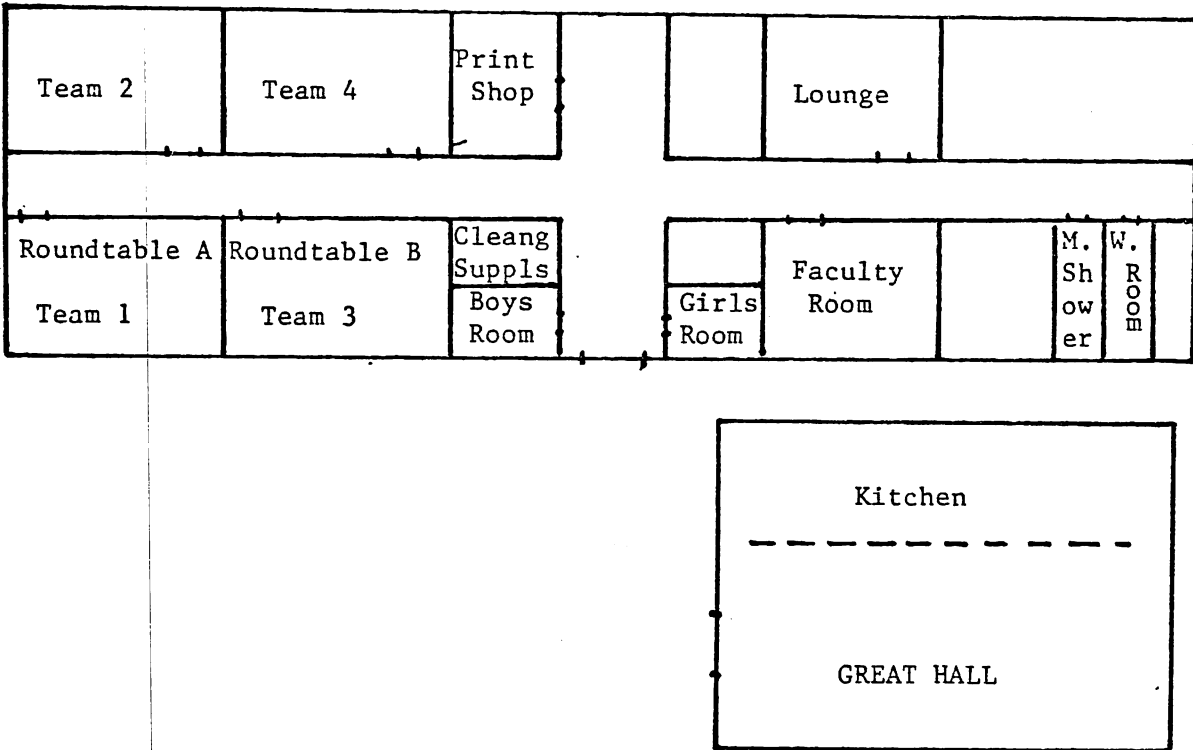

← to Mathews Memorial Dr.
and Attendance Center

LEFLORE AVE.

Drive-
way

CHURCH
BUILDING

MEN'S

STORAGE

DORM

R

R

WOMEN'S DORM

R

R

RESIDENTIAL FACILITIES



PACE

**HUMAN DEVELOPMENT
TRAINING SCHOOL**

DELTA PACE

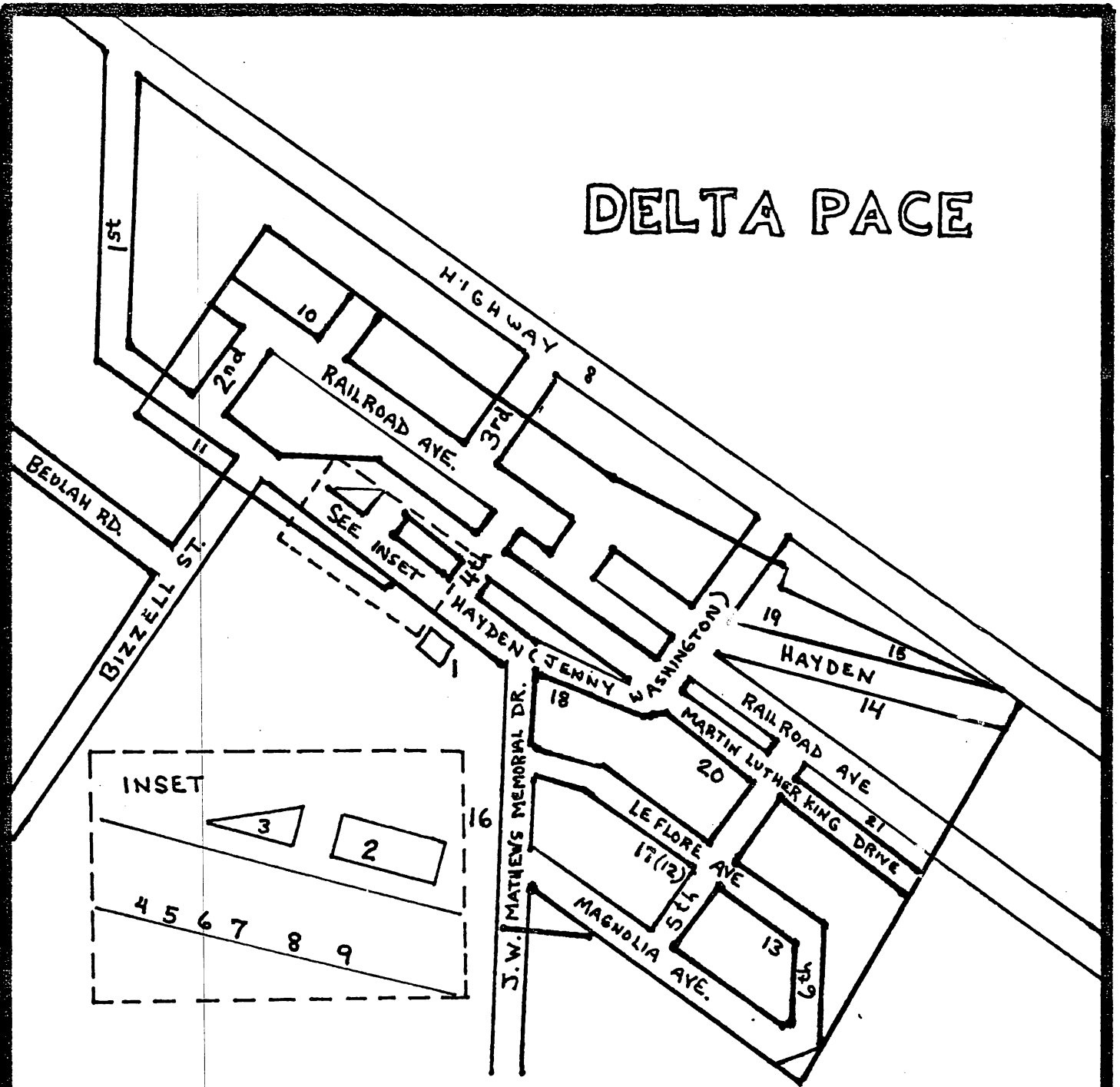

- | | | |
|----------------------------|---|----------------------------|
| 1) ICA Office | 8) Laundromat | 15) St. Peter's Rock |
| 2) Town Hall | 9) Old Town Hall, Youth Dance Hall (Public Phone) | 16) Pace Attendance Center |
| 3) Post Office | 10) Baptist | 17) Headstart Buildings |
| 4) Lum's | 11) Methodist | 18) Restaurant (Blue Bldg) |
| 5) New Industry (Mr. Food) | 12) Spangle Banner | 19) Baseball field |
| 6) Commercial Building | 13) Pace Miracle Revival Center | 20) Elbethal Church |
| 7) Preschool | 14) St. Peter's M.B. | 21) Wats Chapel Church |

HUMAN DEVELOPMENT TRAINING SCHOOL CURRICULUM DESIGN

ECONOMIC DEVELOPMENT					SOCIAL DEVELOPMENT					CULTURAL DEVELOPMENT				
Week 1					Week 2					Week 3				
20th Century Perspectives					UR Images					Trends of the Future				
Economic	HERITAGE EXCURSION	WORK DAY	REFLECTION	Meal	Social	URBAN EXCURSION	TOWN MEETING DAY	REFLECTION	Meal	Cultural	ART EXCURSION	DOCUMENTATION	REFLECTION	
Round Table					Round Table					Round Table				
Cycle					Cycle					Cycle				
Leadership Methods	Imaginal Leadership Lab	celeb.			Workshop Methods	Community Forum Lab	celeb.			Motivation Methods	Profound Humanness Lab	celeb.		

7

June 1977

PROGRAMMATIC CHART



Toward the Actuation of Comprehensive Human Development Projects on the Local Level

thirty six programs – nine structures – three dynamics – one project

A ECONOMIC DEVELOPMENT LOCAL PRODUCTIVITY toward self sustenance	B HUMAN DEVELOPMENT LOCAL MOTIVITY -toward self-confidence	C SOCIAL DEVELOPMENT LOCAL SOCIALITY -toward self-reliance
Enabling local– COOPERATIVE AGRICULTURE 1 expanded cultivation 2 intensified production 3 water delivery 4 equipment pool	Reconstructing local– LIVING ENVIRONMENT 13 domestic housing 14 public facilities 15 village design 16 essential services	Creating local– PREVENTIVE CARE 25 intermediate sanitation 26 total nutrition 27 systematic immunization 28 primary treatment
Developing local– APPROPRIATE INDUSTRY 5 cottage production 6 agro-business 7 processing plants 8 ancillary industry	Catalyzing local– CORPORATE PATTERNS 17 total engagement 18 community commons 19 consensus assemblies 20 corporate workdays	Establishing local– FUNCTIONAL EDUCATION 29 early learning 30 formal schooling 31 youth training 32 adult education
Initiating local– COMMERCIAL SERVICES 9 common marketing 10 local merchandising 11 savings & loans 12 basic transport	Recovering local– IDENTITY SYSTEMS 21 community self-story 22 symbol systems 23 corporate rituals 24 village celebrations	Instituting local– COMMUNITY WELFARE 33 family development 34 women's advancement 35 youth task-force 36 elderly engagement

ECONOMIC, CULTURAL AND SOCIAL PRINCIPLES

ECONOMIC PRINCIPLES

1. Autonomous Unit
2. Monetary Input
3. Monetary Retention
4. Monetary Circulation
5. Global Relatedness

CULTURAL PRINCIPLES

1. Rapid expansion of consciousness
2. Expand interior space
3. Extend interior time
4. Diversify human relationships
5. Expansion of corporate engagement

SOCIAL PRINCIPLES

1. Delimited Geography
2. All Problems
3. All People
4. Depth Issue
5. Symbol is Key

PACE
HDTS

DAILY TIME DESIGN

June 1 - 23, 1980

	DISCIPLINE	TIME	EVENT
MORNING	WAKEUP	6:00 a.m.	Wakeup rite, rising and preparing for the day
	BREAKFAST	6:30 a.m.	Opening Ritual Breakfast/Collegium
		8:00 a.m.	Individual/Space Care
	MODULE/ LABORATORY	8:30 a.m.	Contextual Talk and Interchange
		9:30 a.m.	Snack
		9:30 a.m.	Field Session/Lab Workshop
		11:30 a.m.	Interlude
AFTERNOON	DINNER/ ROUNDTABLE	12:00 noon	Dinner Conversation/Study
		1:30 p.m.	Break
	MODULE/ LABORATORY	3:30 p.m.	Field Session/Lab Workshop
		6:00 p.m.	Preparation for dinner
EVENING	SUPPER	7:00 p.m.	Leadership Methods Dinner/Methods Use/ Evaluation
		8:30 p.m.	Informal Conversation
	PHYSICAL RESTORATION	10:00 p.m.	Sleep

The Daily Ritual

CREATION

ENTRY (Verses 1 and 2)

A time to set forth a new demand,
A time to look into the past,
For without "what has been," there is no "yet to be;"
Nothing that we do then could last.

Refrain:

We stand beyond our life and see,
We stand beyond our death and really see,
What's required of those who give their death to history,
And it is now that we must do
What other ones have always longed to see,
To discover what's required
To set all people free.

No more must we live with poverty,
No more in strife and disarray,
For when Those Who Care create all the earth,
That shall be the new day.

EXIT (Verses 3 and 4)

In those who choose to be all there is
Pain and misery are past,
Transformed because they bring forth human life;
New life never comes but through a death.

Refrain:

The global task now has claimed our lives,
Who knows where our bodies they shall find?
But with us, anew, now the mystery appears,
The meaning of the life of all Mankind.

Refrain:

(Let the Community stand and sing first two verses of the song, "Creation")

Leader: Let us stand before life as those who care
for the world.

Community: Be it so.

ACT I: **L:** Life is never the way we want it.
C: We refuse to accept its promise.
L: Nevertheless we are free to live.
C: Be it so.

(Let the community be seated)

Reading for the Day

(Let the community stand)

ACT II: **L:** This is the day we have on our hands.
C: We give thanks for the life we have.
L: This is our decision.
C: Be it so.

L: Let all the joy mingle in my last song.

Community Left: The joy that makes the earth flow
over in riotous excess.

Community Right: The joy that sets the twin brothers, life
and death dancing,

Community Left: The joy that sweeps in the tempest,
waking all life with laughter,

Community Right: The joy that throws everything it has
upon the dust.

(Let the community be seated)

Address for the Day

(Let the community stand)

ACT III: **L:** We stand before the world and its need.
C: Let us give ourselves to the task.
L: It is to build the Earth.
C: Be it so.

L: Let me not pray to be sheltered from dangers,

C: But to be fearless in facing them.

L: Let me not beg for the stilling of my pain,

C: But for the heart to conquer it.

L: Let me not look for allies in life's battlefield,

C: But to my own strength.

L: Let me not crave, in anxious fear to be saved,

C: But hope for the patience to win my freedom.

Leader: Let us go forth to enact our care for the world.

Community: Be it so.

*(Let the community sing last two
verses of the song, "Creation")*

BREAKFAST

(Repeat after me)

- At the edge of history
- The Future is blowing wildly in our faces
- Sometimes brightening the air
- And sometimes blinding us.

DINNER

(Repeat after me)

- The Task before us now
- If we would not perish
- is to shake off our ancient prejudices
- And to build the earth.

SUPPER

(Repeat after me)

- Action will remove the doubt
- That theory cannot solve.

CLOSING

Leader: These are the times,

Community: We are the people.

(Repeat)

PAGE ATTENDANCE CENTER

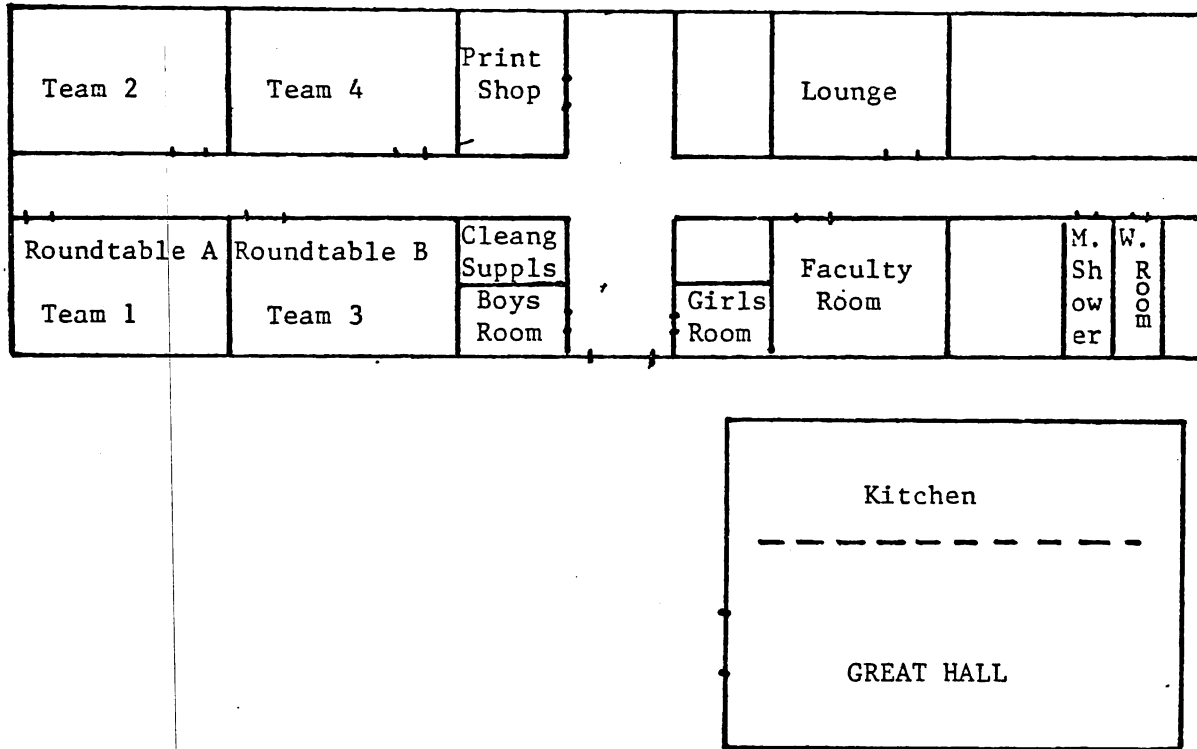

← to Mathews Memorial Dr. and Attendance Center

LEFLORE AVE.

Drive-way

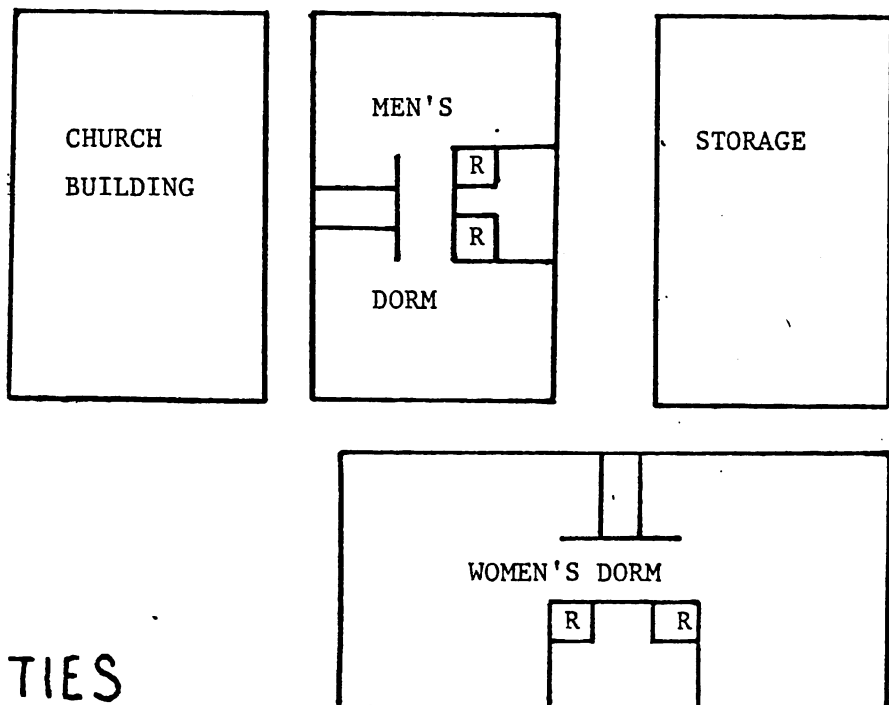

RESIDENTIAL FACILITIES