

PACE

**HUMAN DEVELOPMENT
TRAINING SCHOOL**

<u>CONTENT</u>	<u>PAGE</u>
Table of Contents	1
Map of Pace	2
Pace Grid	3
Curriculum Design	4
Social Process Triangle	5
Programmatic Chart	6
Organizational Chart	7
E., C., & P., Principles	8
Profound Humanness Chart	9
Daily Time Design	10
Breakfast Procedures	11
Rituals	12
Participant Services	13
HDTS Facilities	14

DELTA PACE

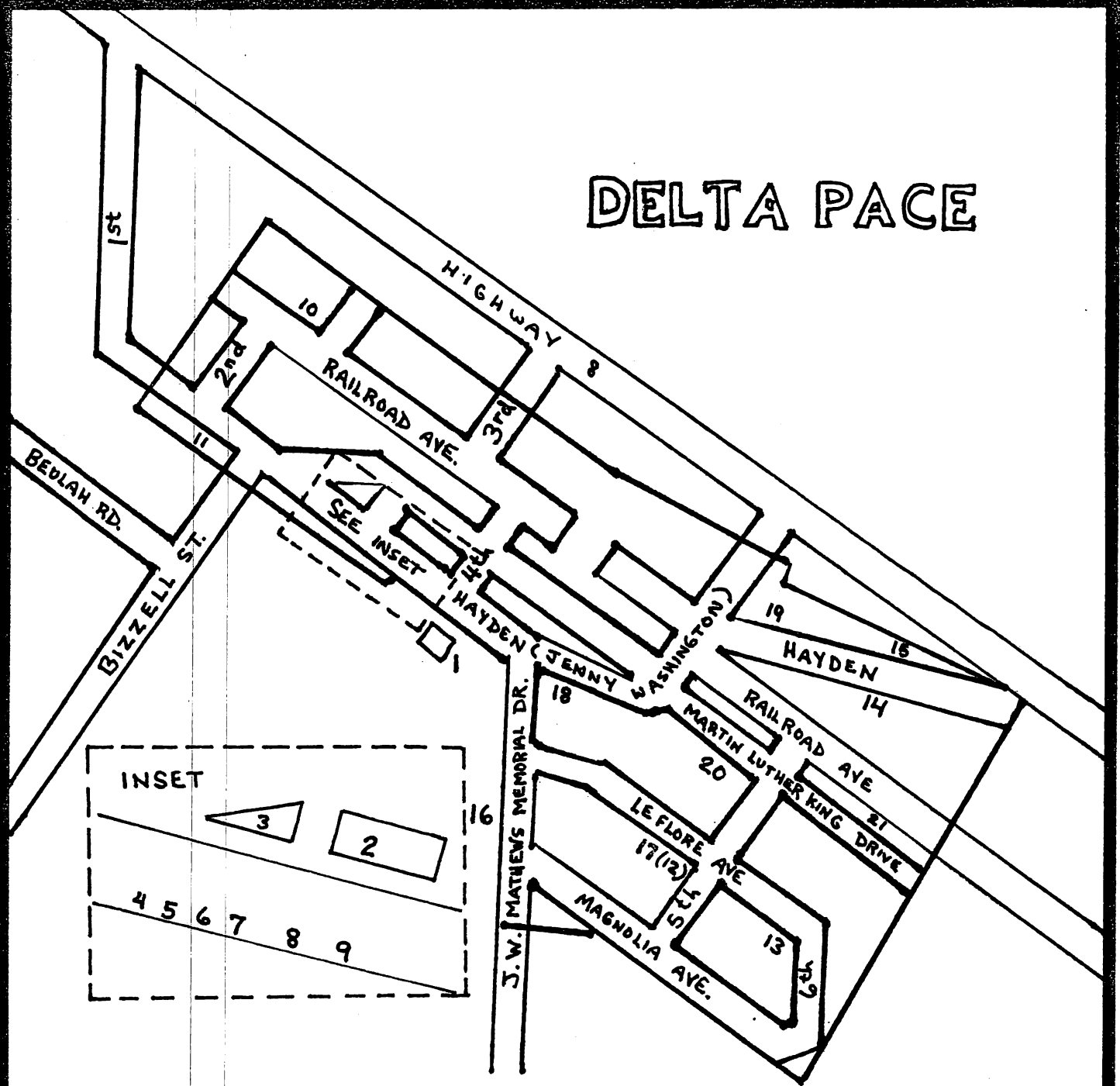

- | | | |
|----------------------------|---------------------------------------------------|----------------------------|
| 1) ICA Office | 8) Laundromat | 15) St. Peter's Rock |
| 2) Town Hall | 9) Old Town Hall, Youth Dance Hall (Public Phone) | 16) Pace Attendance Center |
| 3) Post Office | 10) Baptist | 17) Headstart Buildings |
| 4) Lum's | 11) Methodist | 18) Restaurant (Blue Bldg) |
| 5) New Industry (Mr. Food) | 12) Spangle Banner | 19) Baseball field |
| 6) Commercial Building | 13) Pace Miracle Revival Center | 20) Elbethal Church |
| 7) Preschool | 14) St. Peter's M.B. | 21) Wats Chapel Church |

PACE GRID

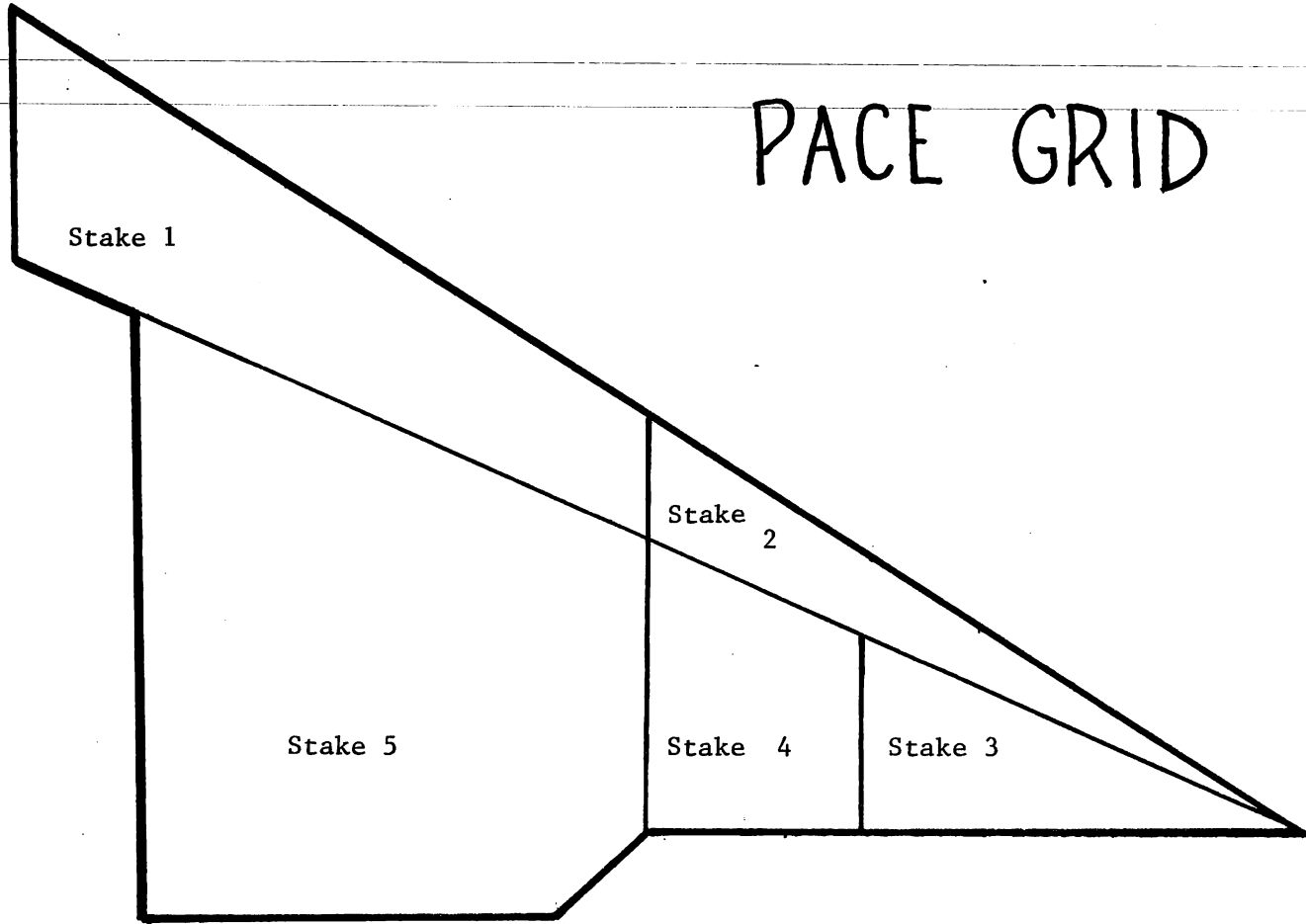

HUMAN DEVELOPMENT TRAINING SCHOOL CURRICULUM DESIGN

ECONOMIC DEVELOPMENT				SOCIAL DEVELOPMENT				CULTURAL DEVELOPMENT			
Week 1				Week 2				Week 3			
20th Century Perspectives				UR Images				Trends of the Future			
Economic	HERITAGE EXCURSION	WORK DAY	REFLECTION Meal	Social	URBAN EXCURSION	TOWN MEETING DAY celeb.	REFLECTION Meal	Cultural	ART EXCURSION	DOCUMENTATION	REFLECTION
Round Table				Round Table				Round Table			
Cycle				Cycle				Cycle			
Leadership Methods	Imaginal Leadership Lab	celeb.		Workshop Methods	Community Forum Lab			Motivation Methods	Profound Humanness Lab	celeb.	

7

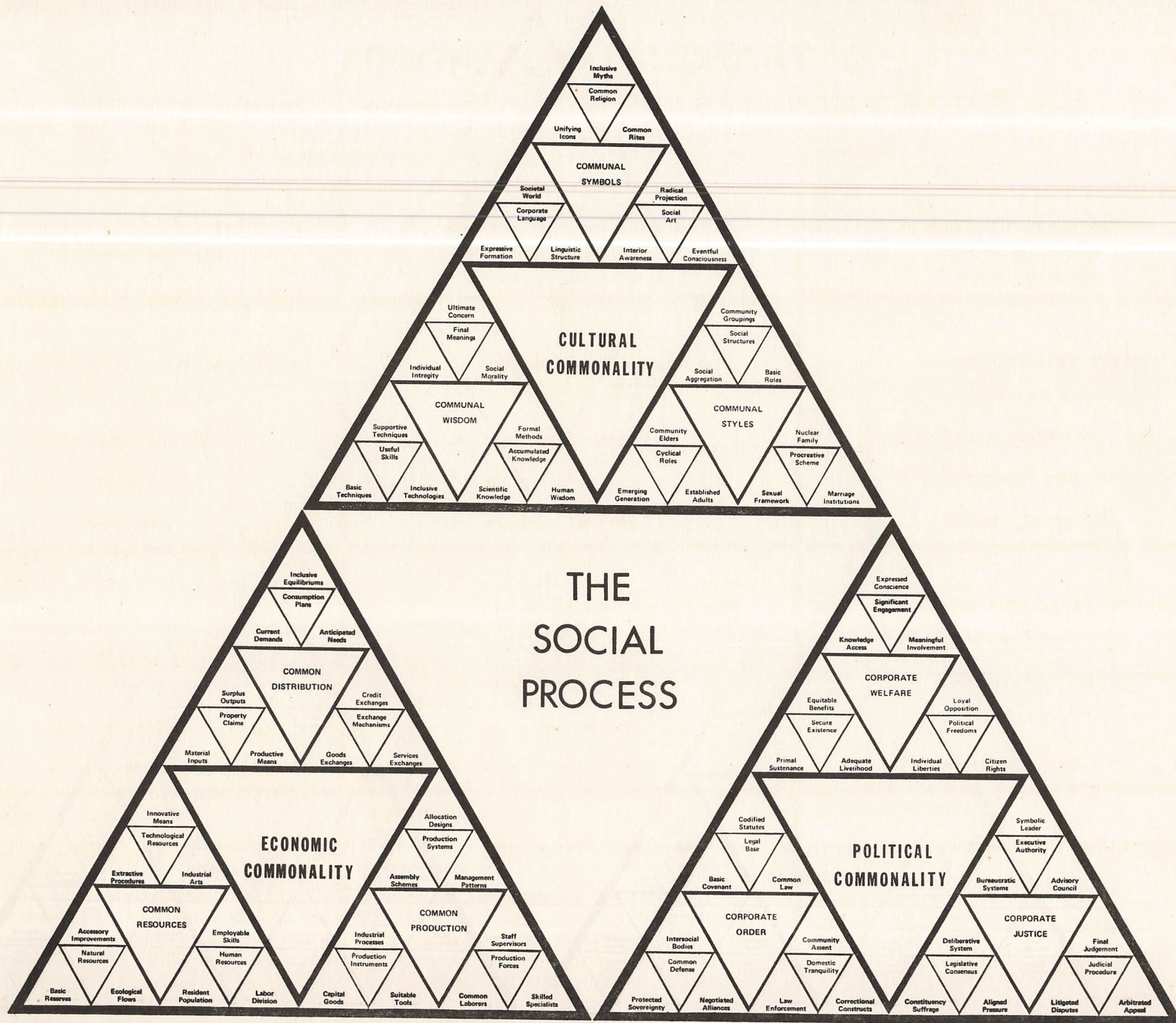

June 1977

PROGRAMMATIC CHART



Toward the Actuation of Comprehensive Human Development Projects on the Local Level

thirty six programs – nine structures – three dynamics – one project

A ECONOMIC DEVELOPMENT LOCAL PRODUCTIVITY toward self sustenance	B HUMAN DEVELOPMENT LOCAL MOTIVITY - toward self-confidence	C J SOCIAL DEVELOPMENT LOCAL SOCIALITY - toward self-reliance
Enabling local— COOPERATIVE AGRICULTURE 1 expanded cultivation 2 intensified production 3 water delivery 4 equipment pool	Reconstructing local— LIVING ENVIRONMENT 13 domestic housing 14 public facilities 15 village design 16 essential services	Creating local— PREVENTIVE CARE 25 intermediate sanitation 26 total nutrition 27 systematic immunization 28 primary treatment
Developing local— APPROPRIATE INDUSTRY 5 cottage production 6 agro-business 7 processing plants 8 ancillary industry	Catalyzing local— CORPORATE PATTERNS 17 total engagement 18 community commons 19 consensus assemblies 20 corporate workdays	Establishing local— FUNCTIONAL EDUCATION 29 early learning 30 formal schooling 31 youth training 32 adult education
Initiating local— COMMERCIAL SERVICES 9 common marketing 10 local merchandising 11 savings & loans 12 basic transport	Recovering local— IDENTITY SYSTEMS 21 community self-story 22 symbol systems 23 corporate rituals 24 village celebrations	Instituting local— COMMUNITY WELFARE 33 family development 34 women's advancement 35 youth task-force 36 elderly engagement



ORGANIZATIONAL CHART

Toward the Actuation of Comprehensive Human Development Projects on the Local Level

I. The Assembly - II. The Secretariat - III. The Commissions - IV. The Guild Network - V. The Stake System

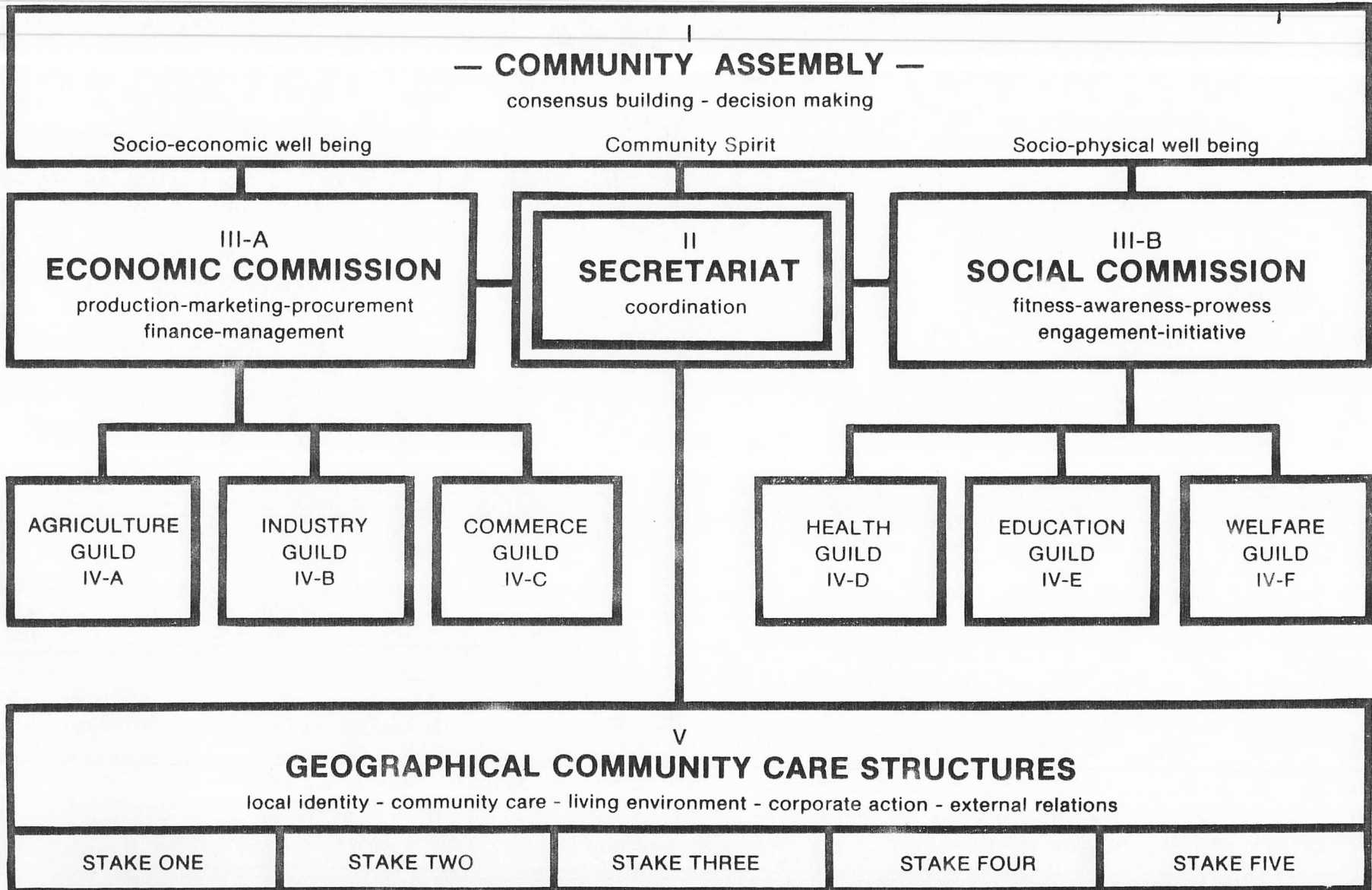

ECONOMIC PRINCIPLES

1. Autonomous Unit
2. Monetary Input
3. Monetary Retention
4. Monetary Circulation
5. Global Relatedness

CULTURAL PRINCIPLES

1. Rapid expansion of consciousness
2. Expand interior space
3. Extend interior time
4. Diversify human relationships
5. Expansion of corporate engagement

SOCIAL PRINCIPLES

1. Delimited Geography
2. All Problems
3. All People
4. Depth Issue
5. Symbol is Key

THE QUALITIES of PROFOUND HUMANNESS



"Civilization is the continual discovery of profound humanity."

INTERNAL STATES of BEING

EXTERNAL MANIFESTATIONS

I	II	III	IV
EVENT unexpected intrusion altered situation immediate response decisional appropriation	ACTION appropriate deeds representational engagement decisional victory manifest intentionality	DECLARATION continual exposure visible sign constant interpretation public accountability	INTEGRITY audacious creation destinal resolve incarnate freedom societal transvaluation
MYSTERY mundane transparentization disclosed unknownness nameless fear dreadful fascination	TOTALITY historical responsibility encompassing unity limitless commitment infinitesimal detail	CREATIVITY universal relativity historical engagement decisional impact sociological creativity	CARE overwhelming reality impassioned detachment universal service perpetual expenditure
CONSCIOUSNESS illuminated relationship impactful imagery paradigmatic insight transrational interpretation	CORPORATENESS focused power covenantal collegiality profound fellowship decisional obedience	PRESENCE inescapable selfhood enigmatic archetype internalized affirmation transparent signification	EFFULGENCE endless affirmation unlimited power paradoxical abundance restless tranquility

PACE
HDTS

DAILY TIME DESIGN

June 1 - 23, 1980

	DISCIPLINE	TIME	EVENT
MORNING	WAKEUP	6:00 a.m.	Wakeup rite, rising and preparing for the day
	BREAKFAST	6:30 a.m.	Opening Ritual Breakfast/Collegium
		8:00 a.m.	Individual/Space Care
	MODULE/ LABORATORY	8:30 a.m.	Contextual Talk and Interchange
		9:30 a.m.	Snack
		9:30 a.m.	Field Session/Lab Workshop
		11:30 a.m.	Interlude
AFTERNOON	DINNER/ ROUNDTABLE	12:00 noon	Dinner Conversation/Study
		1:30 p.m.	Break
	MODULE/ LABORATORY	3:30 p.m.	Field Session/Lab Workshop
		6:00 p.m.	Preparation for dinner
EVENING	SUPPER	7:00 p.m.	Leadership Methods Dinner/Methods Use/ Evaluation
		8:30 p.m.	Informal Conversation
	PHYSICAL RESTORATION	10:00 p.m.	Sleep

OPENING	<p>Gathering around the table set for breakfast, begin the DAILY RITUAL. "Let the community stand."</p> <p>SINGING: "Let us turn to page _____ and sing _____"</p> <p>THE DAILY RITUAL</p> <p>ACCOUNTABILITY: "Let the Pace Human Development Training School stand accountable for its presence at breakfast by Teams. Let the Team Leaders stand. Team One." (Team, 2, 3, 4, etc.)</p> <p>Team Leader: "Team _____ assumes responsibility for the care of its members and reports _____ on special assignment, _____ is ill and checked on, _____ is absent and checked on. All others are present." (When doing symbolic accountability, Team Leaders say: "Team _____ reports that all are present or accounted for.")</p> <p>ABSOLUTION:</p>	H O S T
MEAL RITE	<p>"Repeat after me: "At the edge of history The future is blowing wildly in our faces Sometimes brightening the air And sometimes blinding us."</p> <p>(ALL ARE SEATED)</p> <p>"Let us eat this meal on behalf of _____</p> <p>(someone or group who is doing something relative to the day's work)</p> <p>"Let us feast." (FOOD IS SERVED)</p>	
CONVER- SATION	<p>Read the quote from the Journal (once or more)</p> <ol style="list-style-type: none"> 1. What word, phrase caught your attention? 2. In what situation might someone say this? (and/or) What real life situation does this quote bring to mind? 3. What is the truth about life this passage intends to communicate? 4. Under what circumstances would you want to share this? with whom? <p>Ask for news.</p> <ol style="list-style-type: none"> 1. What recent news event altered your understanding of the world? 2. Which one should we talk about? (May need to get more information.) 3. What is the significance of this in the globe? for us? 	C O N V. L D R.
COLLEGIUM	<p>"Now let's turn to Collegium and sing _____."</p>	
SEND-OUT	<p>ANNOUNCEMENTS (Including agenda for the day)</p> <p>"I send you out to _____. THESE ARE THE TIMES."</p> <p>Community: WE ARE THE PEOPLE."</p>	H O S T

The Daily Ritual

(Let the Community stand and sing first two verses of the song, "Creation")

CREATION

ENTRY (Verses 1 and 2)

A time to set forth a new demand,
A time to look into the past,
For without "what has been," there is no "yet to be;"
Nothing that we do then could last.

Refrain:

We stand beyond our life and see,
We stand beyond our death and really see,
What's required of those who give their death to history;
And it is now that we must do
What other ones have always longed to see,
To discover what's required
To set all people free.

No more must we live with poverty,
No more in strife and disarray,
For when Those Who Care create all the earth,
That shall be the new day.

EXIT (Verses 3 and 4)

In those who choose to be all there is
Pain and misery are past,
Transformed because they bring forth human life;
New life never comes but through a death.

Refrain:

The global task now has claimed our lives,
Who knows where our bodies they shall find?
But with us, anew, now the mystery appears,
The meaning of the life of all Mankind.

Refrain:

Leader: Let us stand before life as those who care
for the world.

Community: Be it so.

ACT I: **L:** Life is never the way we want it.
C: We refuse to accept its promise.
L: Nevertheless we are free to live.
C: Be it so.

(Let the community be seated)

Reading for the Day

(Let the community stand)

ACT II: **L:** This is the day we have on our hands.
C: We give thanks for the life we have.
L: This is our decision.
C: Be it so.

L: Let all the joy mingle in my last song.

Community Left: The joy that makes the earth flow
over in riotous excess.

Community Right: The joy that sets the twin brothers, life
and death dancing,

Community Left: The joy that sweeps in the tempest,
waking all life with laughter,

Community Right: The joy that throws everything it has
upon the dust.

(Let the community be seated)

Address for the Day

(Let the community stand)

ACT III: **L:** We stand before the world and its need.
C: Let us give ourselves to the task.
L: It is to build the Earth.
C: Be it so.

L: Let me not pray to be sheltered from dangers,
C: But to be fearless in facing them.

L: Let me not beg for the stilling of my pain,
C: But for the heart to conquer it.

L: Let me not look for allies in life's battlefield,
C: But to my own strength.

L: Let me not crave, in anxious fear to be saved,
C: But hope for the patience to win my freedom.

Leader: Let us go forth to enact our care for the world.

Community: Be it so.

*(Let the community sing last two
verses of the song, "Creation")*

MONDAY

We can neither applaud nor tolerate irresponsible and wholly selfish individual development. Freedom without commitment is aimless and self-destructive. Here is a tension of opposites--to instill both a vigorous sense of individuality and at the same time a sense of shared purpose with their fellows. The one I respect is the one who has humbly placed himself at the service of a vision greater than himself, but who is able to give himself to a greater good because he has first achieved a mature individuality.

TUESDAY

Freedom then, is not the absence of any outside control, it is the acceptance of limitations. His path can never be as free as that of an airborne bird. He must pick his way painfully through a veritable jungle of alternatives, few of which are satisfactory; none of which is perfect. Man can never be the unconditional master of himself because he neither has complete control of himself, nor of his environment. He is at the mercy of dreams, hopes, fears, and lusts. So that self-will which poses as freedom will only result in a man putting himself under the heel of some subtle tyranny more frightening than any of those from which he fondly thinks he has freed himself.

WEDNESDAY

Experience has taught me that it is never enough to struggle against specific evils; one must also try to create an environment which is hospitable to the growth of the corresponding virtues. All societies are dynamic constantly in a state of flux, so that the passing of time can transform today's virtue into tomorrow's vice. Hence, the battle for justice is never won once and for all; the same battle has to be fought over and over again.

THURSDAY

You will, from time to time, be disillusioned and even hurt when you are let down; when your trust in another human being is repaid by treachery. But it is still better to give another human being the opportunity to rise to your highest expectations of him than to make it a policy to assume the worst in order that you may never be disappointed. Better by far to know both the joy and pain of honest human encounter than to construct a shell which may make you impervious to hurt but also keeps out that searching love.

FRIDAY

At all costs have the courage to fail. We pay a heavy price for our fear of failure. It hinders our growth and narrows the range of our achievements. The learning process will either stop or be restricted within narrow limits unless you are prepared to go on risking failure by trying new things, putting your trust in people who prove to be unknown quantities and exploring uncharted ways that may turn out to be dead ends or else open up new vistas of service and satisfaction.

SATURDAY

It is one of those obvious and easily ignored lessons of nature which applies equally to human society--that birth is always conquering death; that out of decay there springs renewal. The golden age about which we all dream and for which some of us strive is not a static state of bliss where all human problems will be resolved and mankind will live happily ever after. The golden age never dawns and yet paradoxically is always dawning when individuals are predictors and agents of renewal and bearers of it.

BREAKFAST

(Repeat after me)

- At the edge of history
- The Future is blowing wildly in our faces
- Sometimes brightening the air
- And sometimes blinding us.

DINNER

(Repeat after me)

- The Task before us now
- If we would not perish
- Is to shake off our ancient prejudices
- And to build the earth.

SUPPER

(Repeat after me)

- Action will remove the doubt
- That theory cannot solve.

CLOSING

Leader: These are the times,

Community: We are the people.

(Repeat)

TELEPHONE

There is one public phone located opposite the City Hall. Phone messages will be taken at the school office (601-723-6253) and posted in the lounge. The office phone is not available for outgoing personal calls.

MAIL

Incoming mail for HDTS participants will be delivered to the lounge. Outgoing mail may be put in the drop box in front of the Post Office in downtown Pace. The mail is picked up at the Post Office at 4:00 p.m. The Post Office hours are 7:30 a.m. to 4:30 p.m. on weekdays and 7:30 a.m. to 11:30 a.m. on Saturdays. The mailing address for the HDTS is : c/o I.C.A., P.O. Box 269, Pace, MS 38764.

HEALTH

For first aid or health services information contact Joan Priest. The nearest hospital is Bolivar County Hospital in Cleveland. The phone number of the hospital is 1-843-0061.

ACCOMODATIONS

Men's and women's dormitories are located in the Bolivar County Headstart Center on LeFlore Ave. Community residents are hosting women participants for bathing. (Please see separate hosting sheet for details.) We request that women honor the bathing times arranged with their host families. Men's showers are available in the men's bathroom in the school.

LAUNDRY

The Delta Pace Laundromat is located in downtown Pace. The hours are 7 a.m. to 10 p.m. including Sundays. The cost is 50¢ per washer and 25¢ per dryer.

TRANSPORTATION

Transportation for program activities will be provided. There is no public transportation between Pace and surrounding communities. Emergency transportation should be arranged with Molly Shaw.

SUNDAY
OPPORTUNITIES

Sunday will be a time to relax and enjoy the sights of Mississippi. Group transportation by bus or car pool will be provided to nearby recreation in Cleveland or Rosedale.

PARTICIPANT
SERVICES
COORDINATOR

The staff of the HDTS is available to assist you in any way they can. Joan Priest is the services coordinator for the school.

PACE HDTS

FACILITIES

JUNE, 1980

PACE ATTENDANCE CENTER

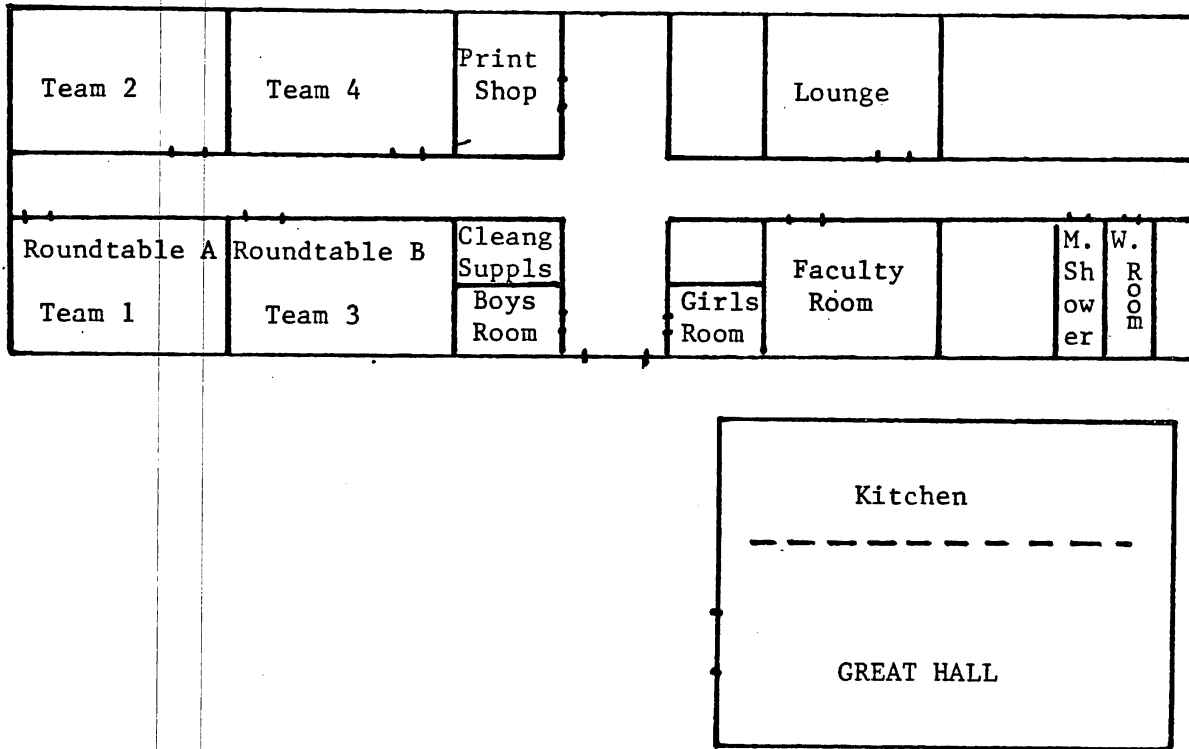

← to Mathews Memorial Dr.
and Attendance Center

LEFLORE AVE.

Drive-way

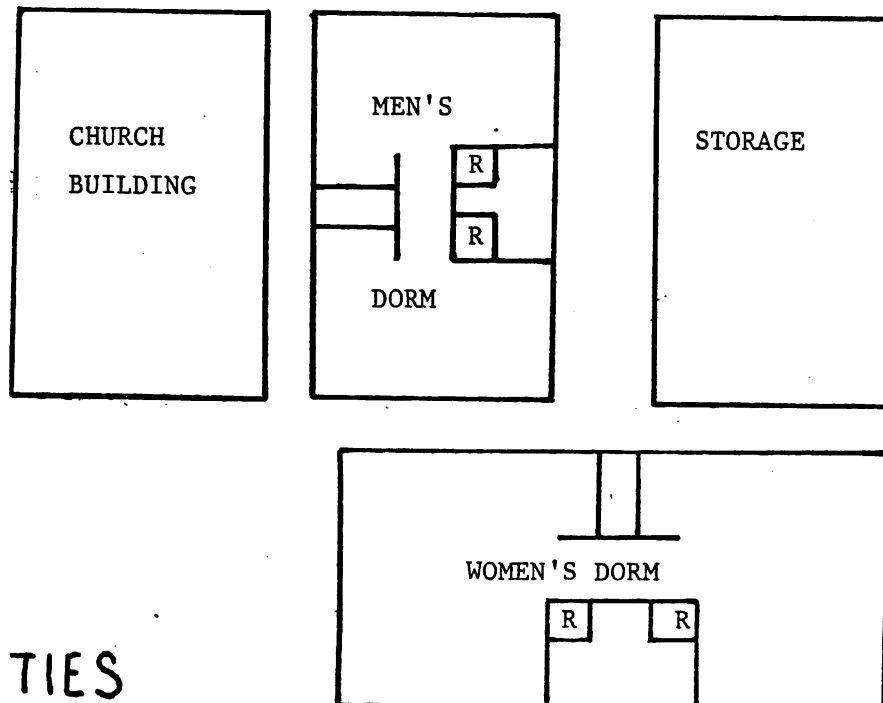

RESIDENTIAL FACILITIES

Day Time	MONDAY 2	TUESDAY 3	WEDNESDAY 4	THURSDAY 5	FRIDAY 6	SATURDAY 7	SUNDAY 8
6:30	Breakfast/Discussions: 20th Century Perspectives					Breakfast/ Introduction to Work Day	Buffet
	What is Human Development?	Scientific Revolution	Urban Revolution	Secular Revolution	Contextual Ethics		
8:00	Individual and Space Care						Breakfast
8:30	ECONOMIC DEVELOPMENT CYCLE			IMAGINAL LEADERSHIP LAB			Individual Reflection Time
	(1) Talk: Principles of Eco. Devt. PACE Site Visits	(3) Talk: Process of Eco. Devt. Business Plan Introduction	(5) Talk: Resources for Eco. Devt. Business Plan Completion	HERITAGE EXCURSION Visit of Historical Sites	(2) Community Images of Time and Space	COMMUNITY WORKDAY	
12:00	Lunch - Roundtable Discussion "The Journey of Care"				Lunch: Hosting Methods		(3) Imaginal Methods for Study, Con- versations, Talks
3:30	(2) Technical Resource Panel	(4) Business Plan Research	(6) Business Plan Review and Presentation				
6:00	Evening Preparation						
7:00	Dinner - Leadership Skills Training "Leading Group Discussions"			(1) Dinner: The Concept of Imaginal Ed	(4) Dinner: Community Journey	Dinner and Celebration	Dinner: Review of the Week
8:30	Time in the Lounge			Time in the Lounge			

HUMAN DEVELOPMENT
 TRAINING SCHOOL
 PACE, MS

CURRICULUM DESIGN: WEEK I
ECONOMIC DEVELOPMENT

JUNE ¹⁻²²~~9-29~~, 1980

W e e k	<u>ECONOMIC CYCLE</u>			<u>IMAGINAL LEADERSHIP LAB</u>			
	DAY	MONDAY	TUESDAY	WEDNESDAY	THURSDAY	FRIDAY	SATURDAY
BFK	social context						
	Human Devel. is...	Scientific Revolution	Urban Revolution	Secular Revolution	Contextual Ethics	Work Day Context	D
M O R N I N G	PRINCIPLES	PROCESS	CONCEPTS	E X C U R S I O N	Space/Time	W O R K	I
	Pace Site Visit	Orientation to task	Prepare Final Product		Gridding		O
LUN	Art Form Conversation Pedagogy Lab						D
A P T E R N O O N	Introduction to technical Resources	Business Package Rough Draft	Final Report	Imaginal Education	Tools	A Y	N
				Charting	Talk		I
E V E N I N G	ROUNDTABLE Conversations Study: Kazantzakis Language of the Economic				Curriculum Content	CELEBRATION	CELEBRATIVE MEAL
					Events		

HDTS							
CURRICULUM DESIGN: WEEK II SOCIAL DEVELOPMENT							
W K	SOCIAL CYCLE			COMMUNITY FORUM LAB			REFLECTION
D A Y	MONDAY	TUESDAY	WEDNESDAY	THURSDAY	FRIDAY	SATURDAY	SUNDAY
B R K	UR IMAGES					Community Forum INSIGHTS	D I S C O N T I N U I T Y
	YELLOW	BLACK	WHITE	TAN/BROWN	RED		
M O R N I N G	PRINCIPLES	PROCESS	CONCEPTS	U R B A N	ART OF STRATEGY	SIX	
	SITE VISIT	ORIENTATION TO TASK/ PREPARE PLAN	ENACT PLAN AND CREATE PRODUCTS		WORKSHOP PLANS		
L U N	WORKSHOP PEDAGOGY LAB -----					COMMUNITY	
A F T E R N O O N	INTRODUCTION TO TECHNICAL RESOURCES	ENACT PLAN AND CREATE PRODUCTS	PREPARE REPORT	E X C U R S I O N	ELEMENTS TO DO Comt'y Forum	FORUMS	
			PLENARY		TALKS/TEACHING PLANS		
E V E N I N G	<u>ROUNDTABLE</u> CONVERSATIONS STUDY: KAZANTSAKIS LANGUAGE OF THE SOCIAL			PROFOUND ROLE	STAGING	CELEBRATION	
				DEMONSTRATION Community Forum	PRACTICE		







HDTS

CURRICULUM DESIGN: WEEK III
CULTURAL DEVELOPMENT

Week	<u>CULTURAL CYCLE</u>			<u>PROFOUND HUMANNESS LAB</u>			Sunday	
	Monday	Tuesday	Wednesday	Thursday	Friday	Saturday		
B f k	Journal/News Conversations							
	7 Revolutions	Pace Panel	Destinal Role	Journal News Conversations				
M o r n i n g	Break/Preparation			Break/Preparation			D o c u m e n t a t i o n	
	Principles	Process	Vehicle: Iron Man Mythology	Profound Humanness Lab				Final Commissioning
	Site Visits	<u>Indicative Battleplan</u> Community Node						
L	Lunch Pedagogy			Lunch Pedagogy			D i s c o n t i n u i t y	
A f t e r n	Technical Visits	<u>Indicative Battleplan</u> (cont'd)		Profound Humanness Lab	School Evaluation	School Celebration		
E v e n i n g	<u>Roundtable</u> Conversations Study: Kazantzakis Language of the Cultural		Worknight Celebration		Dedication Celebration Community Center			

RAT. OBJ.
To set the context for Human Development Training School

EXIST. AIM
"I can be part of the New Village Movement through my town."

DAWN OF NEW ERA		SOCIAL PROCESS 		INTEGRATED COMMUNITY DEVELOPMENT AT LOCAL LEVEL		NEW COMMUNITY MOVEMENT	
RAPID CHANGE	Historically, century is now like 10	SUSTAINS 	Resources	SELF-SUFFICIENCY	Barrenness to Fruitfulness	SIGN OF HOPE	Visible Excellence
	New 20th C. is Meaning		Production		Unemployment to Production		Corporate Efforts
	Perpetual Change		Distribution		Blightedness to Distribution		Rapid Change
	Global Relatedness		Imbalance-Local as Absence of Production		Local Ventures		Telling Story
RISE of LOCAL	Earthrise	ORGANIZES 	Order	SELF-RELIANCE	Debilitation to Vitality	MOVES on MORAL ISSUE	 15% use 85%
	Take Charge of Own Destiny		Justice		Inaptness to Capability		All Goods
	Establish Local Structures		Welfare		Isolation to Dignity		All Gifts
	Autonomous Inputs		Imbalance-External Order/Control		Local Structure		All Decisions
REQUIRE METHODS	Contra-Planning/diction	GIVES MEANING 	Wisdom-	SELF-CONFIDENCE	Transience to Stability	NETWORK of Comm.	Project-17 USA 2 Canada
	Teamwork/Tactical		Style-		Observation to Participation		Towns on Move (MS)
	Motivity/Events		Symbol-		Victim to Significance		Clusters in Region (CA)
	Local Decision-Making Mechanism		Imbalance-Wisdom Comm. to 5 Schools		Local Motivity		Urban Neighborhoods
REQUIRE SCREENS MODELS (Student Manual)	Local Programs	20th CENTURY SITUATION	Imbalance 	HUMAN FACTOR	Self-Conscious/Pro-found	INTER-CHANGE	Methods of Operation
	Local Organization		Continual Rebalancing		Song/Story/Rite		Newsletters
	P H Grasps the Depths		Direct: Pressure Points		On Be $\frac{1}{2}$ Of		Gatherings/Site Visits
	Comprehensiveness Social Dynamics		Indirect: Whistle Points		Transformed Lives		Networks of Support

RAT. OBJ.

To set the context for Human Development Training School

EXIST. AIM

"I can be part of the New Village Movement through my town."

DAWN OF NEW ERA

SOCIAL PROCESS



INTEGRATED COMMUNITY DEVELOPMENT AT LOCAL LEVEL

NEW COMMUNITY MOVEMENT

RAPID CHANGE

Historically, century is now like 10
New 20th C. is Meaning
Perpetual Change
Global Relatedness

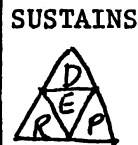

SUSTAINS

Resources
Production
Distribution
Imbalance-Local as Absence of Production

SELF-SUFFICIENCY

Barrenness to Fruitfulness
Unemployment to Production
Blightedness to Distribution
Local Ventures

SIGN OF HOPE

Visible Excellence
Corporate Efforts
Rapid Change
Telling Story

RISE of LOCAL

Earthrise
Take Charge of Own Destiny
Establish Local Structures
Autonomous Inputs



ORGANIZE

Order
Justice
Welfare
Imbalance-External Order/Control

SELF-RELIANCE

Debilitation to Vitality
Inaptness to Capability
Isolation to Dignity
Local Structure

MOVES on MORAL ISSUE

15% use 85%
All Goods
All Gifts
All Decisions

REQUIRE METHODS

Contra-Planning/diction
Teamwork/Tactical
Motivity/Events
Local Decision-Making Mechanism



GIVES MEANING

Wisdom-
Style-
Symbol-
Imbalance-Wisdom Comm to 5 Schools

SELF-CONFIDENCE

Transience to Stability
Observation to Participation
Victim to Significance
Local Motivity

NETWORK of Comm.

Project-17 USA
2 Canada
Towns on Move (MS)
Clusters in Region (CA)
Urban Neighborhoods

REQUIRE SCREENS MODELS (Student Manual)

Local Programs
Local Organization
P H Grasps the Depths
Comprehensiveness Social Dynamics

20th CENTURY SITUATION

Imbalance
Continual Rebalancing
Direct: Pressure Points
Indirect: Whistle Points

HUMAN FACTOR

Self-Conscious/Profound
Song/Story/Rite
On Behalf Of
Transformed Lives

INTER-CHANGE

Methods of Operation
Newsletters
Gatherings/Site Visits
Networks of Support

SPATIAL CONSCIOUSNESS		DECISIONAL RHYTHM		HUMAN RELATIONSHIPS		DESTINAL ROOTAGE	
CHANGE IN INTERIOR SPACE	Urban Population Explosion	CHANGE IN INTERIOR TIME	Urban Technolog. Breakloose	CHANGE IN RESPONSIBLE RELATIONSHIPS	Urban Community Formation	CHANGE IN SOCIAL ROOTS	Urban Vocational Possibilities
	Transportation Revolution		Media Revolution		Racial Consciousness		Frontier Mindset
	Urban Planning		Organizational Efficiency		Phases Consciousness		Individual Breakloose
	Mixed Cultural Heritage		Accelerated Timelines		Social Re-Alignment		Destinal Responsibility
SHIFT: PAROCHIAL TO GLOBAL	Global Perspective	SHIFT: CONTINUOUS TO SIMULTANEOUS	Pace Increased	SHIFT: INTIMATE TO STRUCTURED RESPONSIBILITY	Contacts	SHIFT: PAST TO FUTURE	Personal Significance
	Inter-related Responsibility		Crisis Rhythm		Pluriform Responsibility		Community Consensus
	Expansion Implication		Simultaneous Rhythm		Structured Responsibility		Future Needs
	Intentional Design		Shifting Rhythm		Mobile Society		Civilization Needs
PAROCHIAL (PURAL) MINDSET	Exterior Spaciousness	CONTINUOUS RHYTHM	Nature Rhythm	INTIMATE MUTUALITY	Accountability	ROOTS IN THE PAST	Race Preservation
	Protective Security		Cyclical Time		Primal Community		Skill Continuity
	Survival		Task Completion	Depth Care			Quality Control
	Autonomous		Framework for Decisions	Family Extension			Family Integrity
GLOBAL (URBAN) MINDSET	Interior Spaciousness	SIMULTANEOUS RHYTHM	Task Oriented Rhythm	STRUCTURED RESPONSIBILITY	Covenantal Responsibility	ROOTS IN THE FUTURE	Future Anticipation
	Selective Space		Selective Tasks		Selective Relations		Selective Skills
	Global Interrelatedness		Shaping Consciousness	Foundational Strategy			Vocation vs. Family
	Universalized Problems		Creative Time Rationale	Total Needs			Marriage to City

Backup

INTERNATIONAL TRAINING INSTITUTE
SEMINAR ASSIGNMENTS

WEEK I

CS-I THE CULTURAL REVOLUTION
COURSE A
MONDAY - TUESDAY

SEMINAR I

Ortega y Gasset, The Structure of Life, The Substance of History

1. Chart the paper beginning with paragraph 5 and chart 9 paragraphs.
2. List three inescapable problems which for you are given by life.
3. List some of the new "universes" that have been created by or in the Post-Modern World. What have they done to "old solutions"?

SEMINAR II

Mumford, The Myth of Megalopolis

1. Chart the section "Cultural Function", pp. 4-5 (8 paragraphs).
2. List three basic fears you have in urban life and the three basic demands on people in urban life.
3. Draw an abstract picture of the city.

SEMINAR III

Eliade, Observations on Religious Symbolism

1. Chart the whole paper by paragraphs (15 paragraphs).
2. Workshop questions: 3 poetic words from another culture.
3 symbols from this continent.
3 symbols of your people.
3. Locate the symbolism in Eliade's paper in the movies of your culture.

SEMINAR IV

Sartre, The Philosophy of Revolution

1. Chart the whole paper by paragraphs (15 paragraphs).
2. Describe the differences between the idealistic and communist presuppositions to action.
3. What is basic in Sartre's alternative?

ULTIMATE ENCOUNTER		DEPTH RESPONSE		SPIRIT STRUGGLE		HUMAN CERTITUDE	
DEEPS OF LIFE	Experience Awe/Mystery	RESPONSE TO THE ULTIMATE	Demands Response	DEMONIC POWERS	Demons and Angels	QUEST FOR CERTITUDE	Struggle: How Can I Know?
	Continual Up-againstness		No Ethical Truth		Internal Warfare		In Life Decisions
	Struggle at all Points		Ambiguous Uncertainty		Conquering Devil		Knowing Nothing
	Intrusion		Solitary Man Struggle		Temptation is Reductionism		Risking Everything
SHIFT: EDGE TO CENTER	Encounter Beyond Life	SHIFT: ETERNAL TO TEMPORAL	Conformity to Creating	SHIFT: SELF POSSESSION TO SELF DIRECTION	Controlled by or Controller	SHIFT: AUTHORITY TO AUTHEN- TICITY	Past: Powerful Metaphors
	Impingement in Midst of Life		Question of morals		Powerless to Powerful		Past: Searching Right Answers
	Seeking Mystery to Encount. Myst.		What is right to What is Necessar		Victimization		Present: Ambigu. Situation
	Authentic Exper. is same in Both		From finding pat to Rebuild. Mod.		Decision: Default or Intentional		Present: Life Experience
SUPER- NATURAL	Two Layers of Reality	ETERNAL PATTERNS	Right/Wrong Good/Evil	NATURAL POWERS	External Forces	CERTAINTY IN AUTHORITY	Wisdom of Old
	Soul-sensitive to Supernatural		Self-Justifica- tion		Hereditary Factor		Seeking Justification
	Nature Meets Omnipresent		Eternal Guidance		Environment Factors		Bible, Church, Law
	Death-Hell		Platonic Reason		Psychology Factors		Adequate Defense
EVERYDAYNES	Breaking-in Comprehensive	TEMPORAL MODELS	Everyman creates Models	HISTORICAL DECISIONS	You Are Network of Relationships	CERTAINTY IN AUTHEN- TICITY	That's Way It Is
	Futuric Impingement		Fluctuating Data		You Decide yours/ others Moods		Living Life in Midst of Dec.
	Intentional Impingement		Ordering Chaos		You run Relationships		Finally Never Know
	Center is Human Consciousness		Continuous Dec. to Create		You Decide course of History		Risk Your Being

INTRODUCTION: The History of the City as it has progressed from the temple and the Stronghold to the Marketplace, is not a recent development but a reality that shapes communities as civilizations grow in past memories and future visions.

POETRY: Eisley, THE SLIT, pp. 4-5

- I. Spatial Consciousness:** The internal and external spatial consciousness of man has shifted from the parochial to the global.
- A. Change in Interior Space:** Interior space, due to the crowded urban population explosions, the shortening of distance with the transportation revolution and designing of urban space, and the rise of diverse cultural images of space within the city, has expanded the interior grasp of local space as it relates to every other local space.
 - B. Shift: Parochial to Global.** The shift in style is a result of seeing communities in a global perspective, thus seeing responsibility in its inter-relational dynamics, the implications of expansion globally, and the necessity for intentional use of local space in terms of global needs.
 - C. Parochial Mindset:** In the past, the mindset necessary for survival was to create a specific geographical arena for responsibility, resulting in a limited interior context for dealing with spacious exterior geography.
 - D. Global Mindset:** Today, the mindset that determines style is created by expanding the internal context to include the globe in every local decision while at the same time having less space to work in externally.
- II. Decisional Rhythm:** The internal and external decisional rhythm of man has shifted from the simple, regular and predictable to the complex, irregular and unpredictable.
- A. Interior Time:** As a result of urban technological breakthroughs, such as instantaneous communication, organizational efficiency and accelerated timelines that have altered time needs, man's interior sense of time has shifted to a simultaneous time rhythm of "spinning all plates at once."
 - B. Shift: Continuous to Simultaneous:** The shift in style occurred with the pace increase of the urban revolution and the operational rhythm of decisions that issue from regular crisis, shifting priorities and simultaneous needs.
 - C. Continuous Rhythm:** In the past, man's style was shaped by the natural rhythm of day-night, the seasons and the agricultural calendar, thus reducing decisions down to an agricultural framework.
 - D. Simultaneous Rhythm:** Today, the mindset that determines style is shaped by the urban rhythm of making decisions out of an urban task-oriented rationale, thus creating the necessary priorities that enable continuous, rapid and simultaneous decisions.

COLLEGIUMS WEEK I

HDTs

THE CULTURAL REVOLUTION
LECTURE V

CONTEXTUAL ETHICS

1979-80

GRC:Chicago

MORAL METAPHORS		TRAPS OF CONTEXTUAL ETHICS		MODEL BUILDING		DESTINAL DECISION	
ALL MEN HAVE ETHICAL SYSTEMS	Must Act	TEMPORAL SUCCESSIVENESS	Each Moment New Context	GEO-SOCIAL GRID	Levels	DYNAMIC	Never Complete Yet Now
	Must Have Guides		Immediacy Subjectivity		Everyone Has Grid		Corporate Yet Mine
	Must Have Process of Selection		Spontaneity		Global Grid		Not Abstract
	Yes and No		No Structures No Plans		Global-Cultural Dynamics		My Life
COLLAPSE OF GOOD AND EVIL	goals/ends/means Character/Purpose Deterministic	SPACIAL REDUCTIONISM	Narrow Range of Values	GEO-SOCIAL ANALYSIS	Economic	IMPLEMENTATION PLAN	Goals
	Finite Metaphor		Increase Values Radicalizes Dec.		Political		Strategies
	Eternal End		All Globe All History		Cultural		Tactics
	Ult. Blessedness		Revolutionary		Indicative Reality		Troops
INADEQUACY OF RIGHT AND WRONG	Punishment/Reward Conscience	THE MODEL	Scientific Contribution	GEO-SOCIAL PROBLEMAT	Civilizational Contradictions Imperatives	TIME LINE	4-year
	Authoritarian		Holds Decision		Dehumanizing Conditions		Next Year
	Finite Metaphor		Relative Stability		Context of Vision		Quarter
	Eternal Law Law of God		Open Temporal				Week
APPROPRIATENESS OF RESPONSIBILITY & IRRESPONSIBILITY	Context/Situation Necessary	LIFE GROUNDING	Depth Rootage	THE NEW MORALITY	No Grid	PUT DEATH ON MODEL	D & th Where
	Our Time Uses This		Comprehensive		Lost in Chicago		Build Your Own Cross
	Inclusive of Other Two		Futuristic		No Analysis		Intentional Death
	Must Operate This Way		Intentional		No Problemat		Residue in History
					Two Men-One a Waling Universe		

INTRODUCTION: The Twentieth Century revolution in ethical decision-making has enabled man to create appropriate methods for responsible decisions.

POETRY: Eisley, The Immense Journey, "Brain", pp. 125-126

- I. In grasping the collapse of finite moral metaphors of the past, man today acts out his life authentically through the embodiment of the new twentieth century ethical metaphor.
 - A. In acting out his life, every man has an ethical system or a set of guidelines by which he determines his responses of affirmation or negation in relation to life's given situations.
 - B. The finite deterministic metaphor of good and evil, virtue and vice, leading to the final promise of ultimate blessedness or eternal damnation has collapsed in the midst of a relativistic universe.
 - C. The finite authoritarian metaphor of right and wrong, based on laws and principles such as the eternal law of God, is no longer adequate for twentieth century decision-making.
 - D. The moral metaphor necessary for our time includes, ~~and~~ moves beyond these to dealing with every situation within its own context toward that which is termed responsible or irresponsible.
- II. Responsible decision-making requires clarity on possible pitfalls with contextual ethics and the discipline to meet these traps with an adequate model.
 - A. The trap of temporal successiveness holds that each moment is a new context and therefore immediacy, spontaneity and subjectivity without an objective plan to inform one's decision-making.
 - B. The trap of spatial reductionism leads to decision-making based on a narrow range of values within a very limited context rather than revolutionary decision-making which holds all relevant values within a global perspective.
 - C. Decision-making based on the basic scientific method enables men to make fundamentally objective decisions which, though relatively stable, are always open to the changing dynamics of history.
 - D. Responsible twentieth-century decision-making is grounded in all of life in that it is rooted in history, comprehensive, intentional, and always aimed at the future.
- III. The process of model-building gives men the only responsible way to answer the one question: "Out of what context did you decide those were the problems to which your life is going to be given?"

What did you see?

What person do you remember?

What activities did you see inmates engaged in?

How did you feel?

When did your mood shift?

Where did you sense change was taking place (in the institution)?

How has your image of prisons shifted?

What new insights did you gain?

How would you talk about a community's responsibility for care for all its residents?

How will this experience influence what you are out to do in your community?

The Human Development Training School provides...

- Methods of identifying the actual human needs in any community.
- Ways to discover local resources, government services and appropriate technology available for meeting these needs.
- Training in methods of corporate leadership for engaging an entire community in common planning and action.



**An old abandoned building was transformed into the Pace
Preschool.**



- Practical experiences in comprehensive and rational thinking.
- An opportunity to explore the ways by which the untapped creativity of local people can be released to catalyze community renewal.
- A new self-confidence about one's ability to provide effective practical help to a community.

The Institute of Cultural Affairs has designed the Human Development Training School based upon 15 years experience in rural and urban field projects. The School is being conducted to share this experience with local community leaders and concerned citizens in all types of communities.

**Pace residents and Xerox representatives create the Pace
Community Park on a Saturday workday.**

PACE, MISSISSIPPI
JUNE 1-22, 1980

HUMAN
DEVELOPMENT
TRAINING
SCHOOL

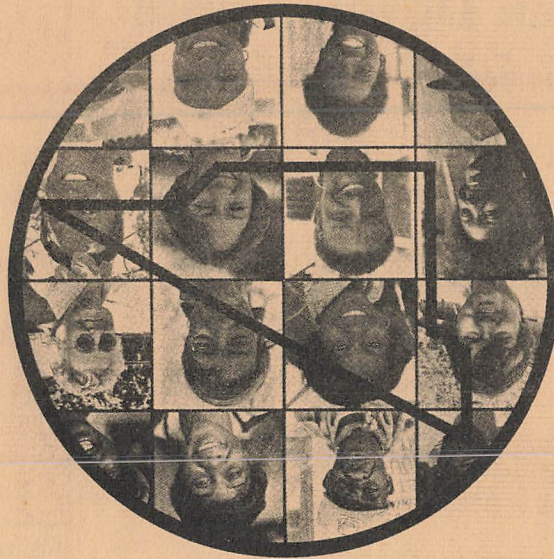

The Institute of Cultural Affairs is a world-wide research, training and demonstration group concerned with the human factor in world development. The ICA, a non-profit organization, presently offers programs in 32 nations. Among these programs are one day Town Meetings, community reformulation projects called Human Development Projects and other specialized consultations and seminars. The ICA receives funding from government agencies, foundations, organizations and concerned individuals.

INSTITUTE OF CULTURAL AFFAIRS

P. O. Box 269, Pace, Mississippi 38764
Telephone (601)723-6745

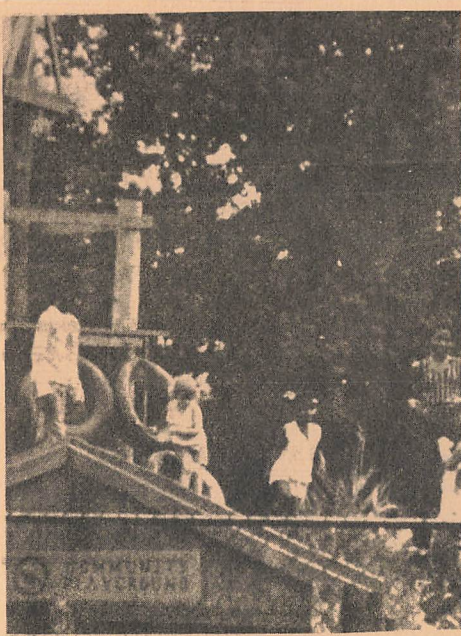

Pace is located in Bolivar County, 8 miles west of Cleveland. A typical Delta community, it has a population of about 600. Pace, once considered a dying town, has been participating in a comprehensive community renewal project for the past three years.

Among the many accomplishments realized by Pace citizens since beginning their Human Development Project in cooperation with the Institute of Cultural Affairs are:

Transformation of a dilapidated downtown store into a preschool for 24 children which also provides 10 local jobs.

A series of Saturday workdays resulting in new street signs, painted trashcans, general community beautification and a unique children's playground.

Opening of a community Laundromat which nets about \$700 a month.

Formation of the Delta Pace Community Association and the Preparation For Tomorrow group which oversee economic development and social activities.

Participants in the Training School will learn how to do the same kind of local revitalization through an orientation in basic principles of economic, social and cultural development. They will additionally gain practical experience by joining with Pace residents in initiating new projects.

TRAINING

**practical methods
for comprehensive
community leadership
development**

THE HUMAN DEVELOPMENT TRAINING SCHOOL is an intensive residential program, focused on developing effective leadership skills and methods in the midst of an active demonstration community.



TOWN MEETING: MISSISSIPPI

Pace and the Institute of Cultural Affairs have not been satisfied to keep these accomplishments and methods to themselves. Since 1977 the community planning methods which Pace has used have been taken to over 300 communities through the Town Meeting: Mississippi Program.

Pace has seen itself as a "Small town with a big future." Hosting the Human Development Training School will provide Pace with an opportunity to launch the next phase of its development and provide a laboratory where others will be able to come and participate first hand in effective community development.

TRAINING

for effective action



HUMAN DEVELOPMENT TRAINING SCHOOL CURRICULUM DESIGN								
Week 1			Week 2			Week 3		
Cycle	Lab	R E F L E C T I O N	Cycle	Lab	R E F L E C T I O N	Cycle	Lab	R E F L E C T I O N
Economic Self-Sufficiency	Imaginal Leadership		Social Self-Reliance	Community Forum		Cultural Self-Confidence	Profound Humanness	
Excursion	Celebration		Excursion	Celebration		Excursion	Celebration	

THE SCHOOL FORMAT

The school will be divided into three one-week sessions. The first week, June 1 - 8, is focused on how a community builds a solid economic base for itself. The second week, June 8 - 15, is concerned with the delivery of social services to the community. And the third week, June 15 - 22 deals with building community identity and corporateness.

THE CURRICULUM DESIGN

In addition to the major three day cycle each week includes a two day lab, a one day excursion, and one day (Sunday) of individual reflective time. The curriculum includes breakfast and evening sessions, Monday through Friday, and a celebration with the community on Saturday night. The emphasis throughout is on practical methods and concepts for empowering local communities.

THE FACULTY OF THE HDTS

The faculty of the HDTS have worked extensively in Human Development Projects across the world and bring tested methods and practical insight to the training school. Students and faculty work closely together in teams, both in the classroom and community, forming an essential collegiality in the life of the school.

“The greatest resource any community has is its people”

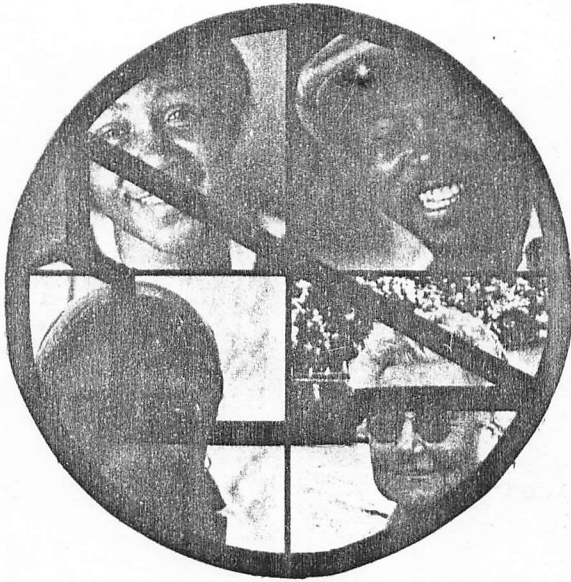

**HUMAN
DEVELOPMENT
TRAINING
SCHOOL**

**PACE, MISSISSIPPI
JUNE 1-22, 1980**

MENU

Barbequed Pork Ribs

Baked Beans

Cole Slaw

Assorted Relishes

Homemade Desserts

Iced Tea

Coffee

We would like to express a special thanks
to all those who assisted with this opening
feast, especially:

The Pace Community Choir

The Table Hosts

The Waiters and Waitresses

The Ladies who provided desserts

PROGRAM

- 4:00 to 5:00 REGISTRATION AND TOURS OF PACE
- 5:30 RECEPTION
- 6:30 WELCOME - W.D. Smith, Principal
Pace Attendance Center
- SINGING - David Zahrt, ICA
ROLL CALL OF LOCAL COMMUNITIES
RITUAL
- OPENING PRAYER
- FEAST
- PACE VICTORIES AND STRUGGLES/
WELCOME - David Washington,
Vice-Mayor
- PACE COMMUNITY CHOIR - Ella Taylor,
Director
- GUEST SPEAKER - Rev. J.Y. Tryce,
Bolivar Co. Asst. Supt. of Schools
- H.D.T.S. CONTEXT - Sharon Turner, ICA
- ANNOUNCEMENTS
- 8:30 CLOSING PRAYER

HDTs DAILY TIME DESIGN

Morning	6:30 a.m.	Breakfast and Collegium
	8:30 a.m.	Module/Laboratory
After-noon	12:00 noon	Dinner and Roundtable
	3:30 p.m.	Module/Laboratory
Night	7:00 p.m.	Supper and Leadership Methods
	8:30 p.m.	Closing

HUMAN DEVELOPMENT TRAINING SCHOOL CURRICULUM DESIGN

ECONOMIC DEVELOPMENT			SOCIAL DEVELOPMENT					CULTURAL DEVELOPMENT			
Week 1			Week 2					Week 3			
20th Century Perspectives			R e f l e c t i o n	Ur Images			R e f l e c t i o n	Trends of the Future			R e f l e c t i o n
Economic	H e r i t a g e	W o r k D a y		Social	U r b a n	T o w n M t g .		Cultural	A r t E x c u r s.	D o c u m e n t a t i o n	
Round Table	E x c.	M e e l		Round Table	E x c u r.	D a y		Round Table	P r o f o u n d H u m a n ' s s L a b	C e l	
Cycle				Cycle				Cycle			
Leadership Methods	Imaginal Ldrship Lab	C e l.	Workshop Methods	Comm. Forum Lab	C e l.	Motivation Methods	Profound Human'ss Lab	C e l			

ON THE STREET WHERE YOU LIVE

I have often walked down this street before ,
But the pavement's always stayed beneath my feet before.
All at once am I several stories high, knowing I'm on the street where you live.

Are there lilac trees in the heart of town?
Can you hear a lark in any other part of town?
Does enchantment pour out of every door?
No, it's just on the street where you live.

And, oh, the towering feeling just to know somehow you are near,
The overpowering feeling that any moment you may suddenly appear.

People stop and stare, they don't bother me ;
For there's nowhere else on earth that I would rather be.
Let the time go by, I don't care if I can be here on the street where you live.

NEW COMMUNITIES

Tune: A World of our Own

From an age of the dawn, a people journeyed on
Till a sail broke the skyline and a new age was born,
Then all those chained and bold, or fevered for the gold
Sought to struggle with a new community.

Chorus:

We're building new communities where everyone can share
All the gifts that belong to each one everywhere;
And we know you will find, that care is the sign
As we live in our new communities.

In a land vast and green with great new industries
Bringing folk from the old lands with their great diversity
You may sense you're alone when struggling on your own
But together we will build community.

Chorus

There's a future open wide, with hope on every side
For a new day is dawning, it is soon to arrive
And together we will strive to keep that hope alive
As we live in a new community.

Refrain (Repeat last two lines)

LIFT EVERY VOICE AND SING

Lift ev'ry voice and sing till earth and heaven ring,
Ring with the harmonies of liberty;
Let our rejoicing rise high as the list'ning skies,
Let it resound loud as the rolling sea.

Sing a song full of the faith that the dark past has taught us,
Sing a song full of the hope that the present has brought us.
Facing the rising sun of a new day begun,
Let us march on till victory is won.

Stony the road we trod, bitter the chast'ning rod,
Felt in the days when hope unborn had died;
Yet with a steady beat, have not our weary feet,
Come to the place for which our fathers sighed?

We have come over the way that with tears has been watered,
We have come, treading our path through the blood of the slaughtered,
Out from the gloomy past, till now we stand at last,
Where the white gleam of our bright star is cast.

God of our weary years, God of our silent tears,
Thou who hast brought us thus far on the way;
Thou who hast by thy might, led us into the light,
Keep us for ever in the path, we pray.

Lest our feet stray from the places, our God, where we met Thee,
Lest our hearts, drunk with the wine of the world, we forget Thee.
Shadowed beneath Thy hand, may we forever stand,
True to our God, true to our native land.

HEY, DELTA PACE

Tune: Delta Dawn

Refrain:

Hey, Delta Pace, what's that new face you have on?
Have you seen a dream and found a way to care?
And do you plan to dare
To find a way to share
Your vision with the state and with the world?

From Greenville to the hills of Tupelo,
From the river to the Gulf of Mexico,
The Magnolia State is looking for a sign,
Of local man's care for all Mankind.

The struggle of the Grey and the Blue
Freed all men to create and build anew.
They joined their hands to clothe and feed the world,
And waited for the promise of their toil.

When the youth of Delta Pace are all grown,
They'll know they do not stand there all alone.
From across the globe the flood of those who care
Will stand and sing the victory we share.

The South is standing tall in a new day,
The Delta land is forging the new way.
Graciousness and kindness are not gone;
Come join us as we sing and march along.

Last refrain:

Hey, Delta Pace has found a brand new face,
We have seen a dream and found a way to care.
And now we plan to dare to be the means to share,
Our victory with the state and with the world.