

# THE HUMAN DEVELOPMENT TRAINING SCHOOL

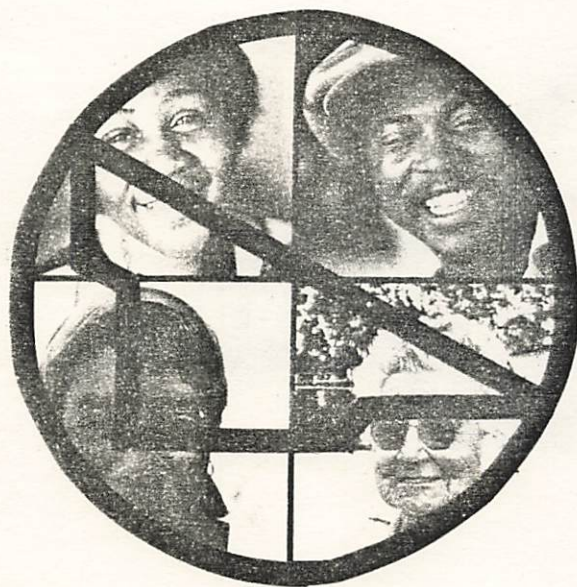

**PACE, Mississippi**

**JUNE 1~21, 1980**

# HUMAN DEVELOPMENT TRAINING SCHOOL

is an intensive residential program focused on developing effective leadership skills and methods in the midst of an active demonstration community.

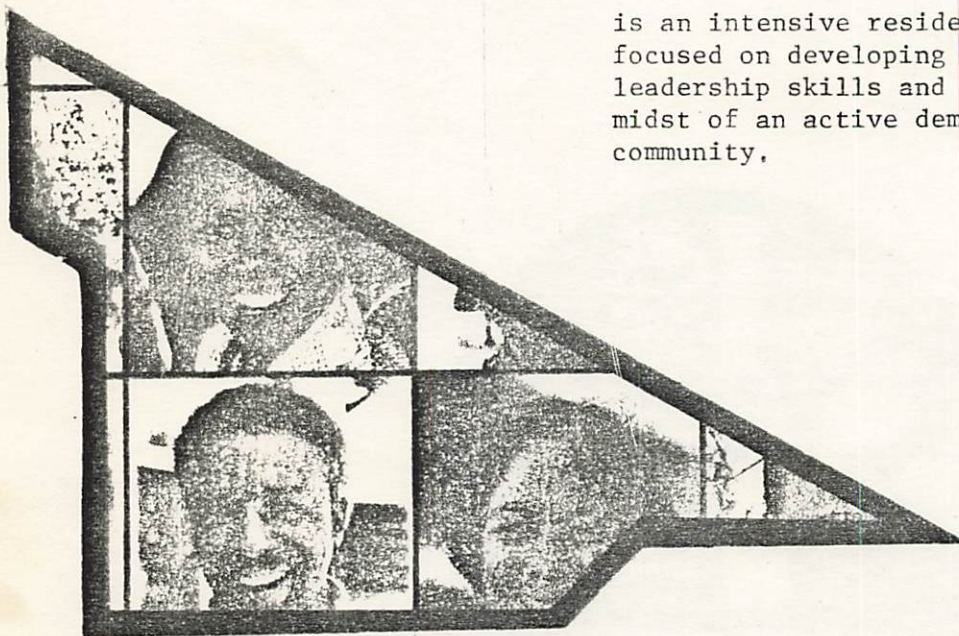

## CONTENTS

CURRICULUM DESIGN  
ECONOMIC CYCLE  
IMAGINAL LEADERSHIP  
SOCIAL CYCLE  
COMMUNITY FORUM  
CULTURAL CYCLE  
PROFOUND HUMANNESSE  
ACKNOWLEDGEMENTS  
PARTICIPANT'S PROFILE  
RESOURCE PERSONNEL

Delta Pace, located in the state of Mississippi 12 miles east of the Mississippi River in Bolivar County is a typical rural delta town. A new resolve has emerged in Delta Pace to rebuild the community as a demonstration for other small towns.

HUMAN DEVELOPMENT TRAINING SCHOOL CURRICULUM DESIGN								
Week 1			Week 2			Week 3		
Cycle	Lab	R E F L E C T I O N	Cycle	Lab	R E F L E C T I O N	Cycle	Lab	R E F L E C T I O N
Economic Self- Sufficiency	Imaginal Leadership		Social Self- Reliance	Community Forum		Cultural Self- Confidence	Profound Humanness	
Excursion	Celebration		Excursion	Celebration		Excursion	Celebration	

The HDTS equips participants to work with their local communities to develop economic self-sustenance, social self-reliance and cultural self-confidence.

Participants develop skills in intellectual, social and motivational methods; refine images of Twentieth Century life; and gain self-confidence in corporate leadership skills.

# ECONOMIC CYCLE

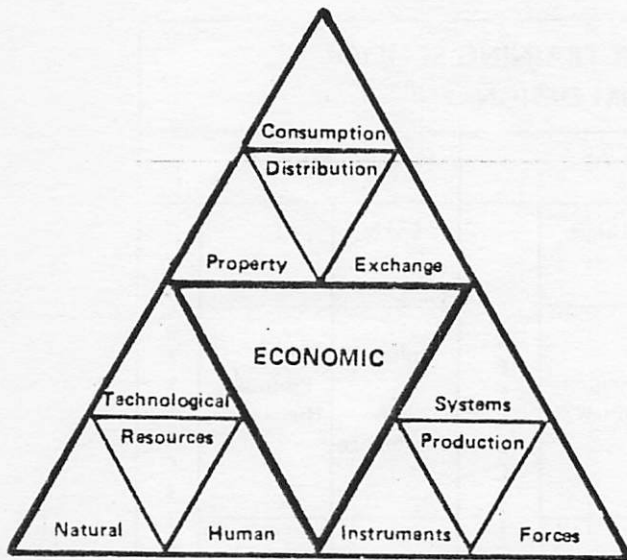

THE ECONOMIC CYCLE orients participants in the fundamental concepts, principles and processes involved in building a comprehensive economic base in a local community.

PRODUCT: Participants divided into three teams to produce a marketing plan, a cash flow analysis and a business projection for a new cultured marble etching industry for Pace.

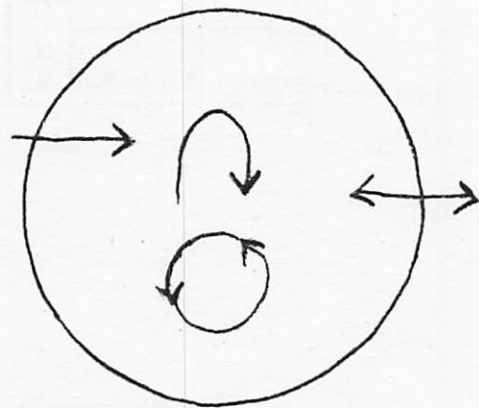

## HERITAGE EXCURSION



B.B. King Concert - Indianola, Mississippi

## Floewood River Plantation

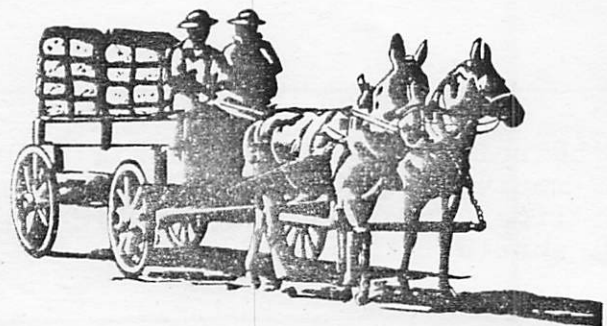

# imaginal leadership

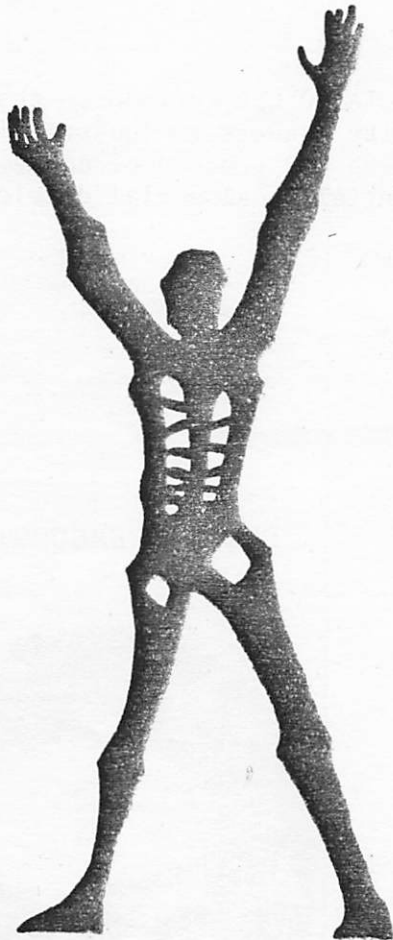

THE IMAGINAL LEADERSHIP LAB described and applied methods for understanding written material, the art of conversation, building a rational talk and designing great community events.

THE WORK DAY was an experience of corporate effort demonstrated by teams repairing a roof and beautifying the grounds of the future community center.

THE CELEBRATION was the occasion for participants planning and executing "A Night South of the Border" complete with pinata, team skits, singing and dancing.

# SOCIAL CYCLE

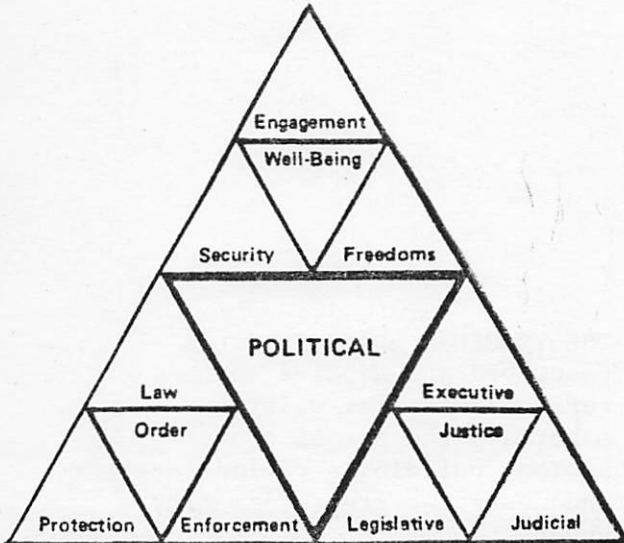

THE SOCIAL CYCLE introduces the community leaders to the principles, resources and process of doing substantial local social development.

## FUTURIC EXCURSION

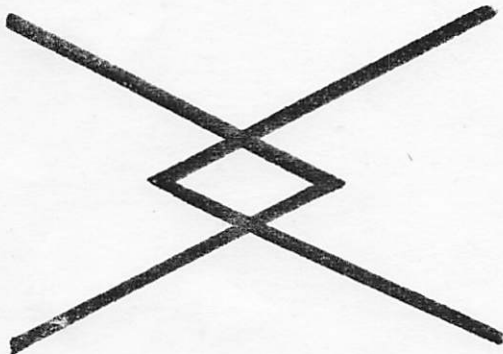

Nikki Giovanni

Mississippi Valley State University

THE PRODUCT: Three teams worked toward a community center for Pace by determining estimates for renovation of the center, gathering possibilities for long ranged funding, and conducting a survey to determine community interest in order to build a consensus.

# Global COMMUNITY FORUM

THE COMMUNITY FORUM LAB started with a demonstration forum using the participants a local citizens. The following sessions focused on leading the workshops, doing the talks and orchestrating the whole event. Participants prepared themselves to do a real forum the following day in other communities.

WELCOME 	CHALLENGES <u>Challenges</u> What is our situation?	INTERLUDE 	PROPOSALS <u>Proposals</u> What can we do?	PLENARY TOWN MEETING DOCUMENT
--	---	--	--	----------------------------------

In the arena of community opportunities, the following conditions exist: people don't participate, no playground, lack of training, no youth activities. This indicates that the underlying contradiction is that the organization isn't strong enough. This contradiction is illustrated by: can't fix houses because people don't volunteer, people don't participate in the organization, people don't raise the money needed, couldn't go on a trip because there wasn't enough interest.

Farrell, Mississippi

We, the citizens of Farrell, in order to have a strong organization and become self-sufficient, propose to have training in grant writing for community funds through: 1) contact of FHA and COI, 2) Survey for other help, 3) Training school.

## BEULAH IS GROWING EVERY DAY

(tune: "Raindrops Keep Fallin' On My Head")

Beulah is growing every day, all the old things are vanishing away  
Nothin' seems to stay...  
But.. you'll never change the conditions by complainin'...  
Because we're free, we know  
Those blues they sang to meet me  
Won't be greeting me,  
It won't be long 'til happiness steps up to greet me....

# CULTURAL CYCLE

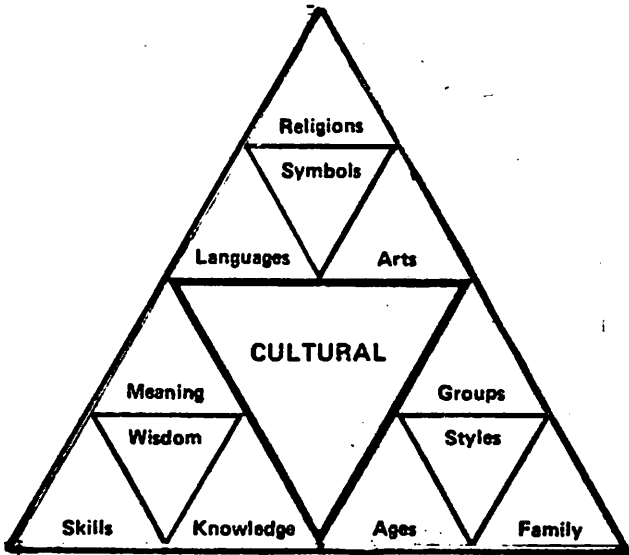

THE CULTURAL CYCLE began with visits to every part of town, a slide show of past accomplishments with a story of Pace and a panel of Pace citizens talking about the future. The cycle centered on discerning the underlying blocks to the vision of the community.

THE PRODUCT: Using the Indicative Battleplanning Method, a five year plan was built that would enhance the space design, community engagement patterns and would sustain Pace's identity.

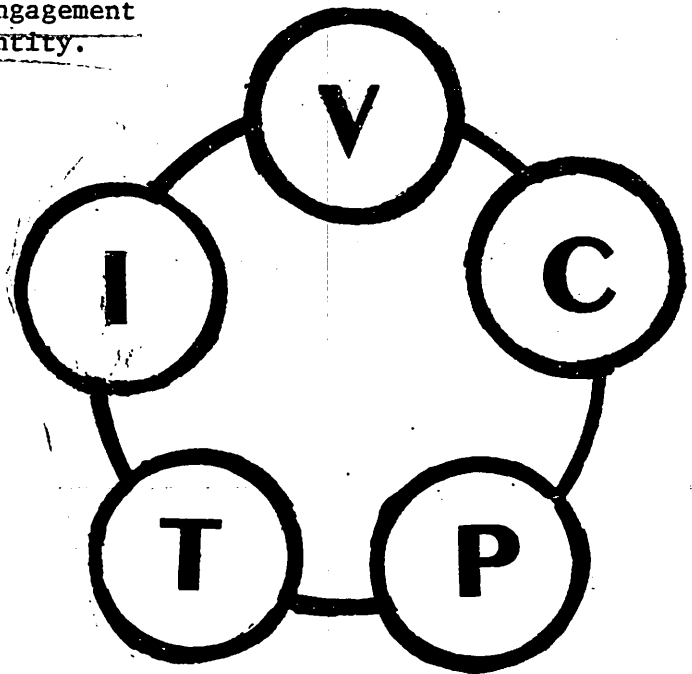

HERITAGE EXCURSION

John Miller  
Photography Exhibit  
Delta State University



# PROFOUND HUMANNESS

THE QUALITIES OF PROFOUND HUMANNESS			
INTERNAL STATES OF BEING			
EXTERNAL MANIFESTATIONS			
EVENT	ACTION	DECLARATION	INTEGRITY
MYSTERY	TOTALITY	CREATIVITY	CARE
CONSCIOUSNESS	CORPORATENESS	PRESENCE	EFFULGENCE

THE PROFOUND HUMANNESS LAB focused the cultural cycle and completed the school. It prepared students to listen in depth to the wisdom of others and to the wisdom of the past, to be disciplined in doing their own thinking and prioritizing.

Evaluation of the school was a time for listing key events, high points and low points and a time to write out how to use the methods of the school within the next three months upon returning to everyone's local community.

## ACKNOWLEDGEMENTS

The Delta Pace Human Development Training School has depended on the broad base of support which has been present throughout the state and nation. The Institute of Cultural Affairs would like to acknowledge the contributions of money, goods and services, and time which hundreds of people have made to allow the Delta Pace HDTS to happen.

Funding for the program has been provided through the generous contributions of individuals as well as from the Community Services Administration. Communities throughout Mississippi and the nation have worked together to raise funds to send participants to the Delta Pace HDTS. Businesses in the Delta, in Memphis, Jackson and New Orleans contributed goods and services such as food, office supplies and equipment.

Finally, acknowledgement is given to the numerous people who have given of their time and energy in order that this program be made available. We wish to express a special appreciation to Rev. J.Y. Trice, Willie Dean Smith, and to the people of Delta Pace for their graciousness and hospitality. The Delta Pace HDTS happened because people invested their time, talents and resources to serve their community.

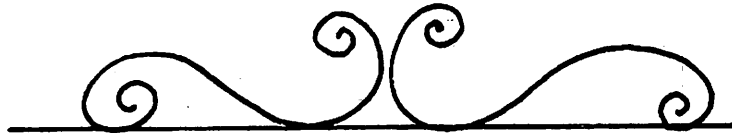

The Institute of Cultural Affairs is an intra-global research, training and demonstration group concerned with the human factor in world development. The ICA, a non-profit organization, presently offers programs in 32 nations. Among these programs are Town Meetings, community reformulation projects called Human Development Projects and other specialized consultations and seminars. The ICA receives funding from foundations, governmental agencies, organizations and concerned individuals.

### THE INSTITUTE OF CULTURAL AFFAIRS

P.O. Box 269  
Pace, MS. 38764

1210 Peabody Ave.  
Memphis, TN. 38104

4750 N. Sheridan Rd.  
Chicago, IL. 60640

The Delta Pace Human Development Training School was designed to accomodate both full-time and part-time participants and faculty. The statistical break-down of the participants is as follows:

Total participants & faculty- 86  
Full-time -one to three wks- 30  
Part-time -four to thirty hr- 22  
Resource people- 14

The participants represented a wide variety of backgrounds and experience in local community work. Of the full-time participants and faculty, 33% were male and 67% were female. The ethnic make up of the school was about 45% black, 50% white and 5% other.

Participants and staff were from Australia, Great Britain, Guatemala, India, Kenya, Philippines, Zambia, Arkansas, Florida, Georgia, Illinois, Louisiana, North Carolina, Pennsylvania, Tennessee, Washington D.C. and Mississippi. A wide range of age groupings from infants to seventy-one years were present. Most of the participants came to the HDTS to learn human development methods for use in Pace and other communities.

#### RESOURCE PERSONNEL

Ron Hudson  
South Delta  
Planning & Development  
Greenville, MS.

Louie Duke  
Vice-President  
The Valley Bank  
Cleveland, MS.

Gloria McQuay  
East Bolivar Co.  
Dept. of Welfare  
Cleveland, MS.

Lawrence Murphy, Jr.  
Farmer  
Pace, MS.

Lowell Kirkbride  
CPA  
Cleveland, MS.

Cloria Martin  
Coahoma Opportunity  
Clarksdale, MS.

Henry Myles  
Assistant  
Congressman David Bowen  
Greenville, MS.

Olivia Leggett  
Bolivar County  
Headstart  
Cleveland, MS.

Clanton Beamon  
Delta Housing  
Authority  
Indianola, MS.

Jane Hannan  
Jones Activity Center  
Clarksdale, MS.

May Murray  
President PFT  
Pace, MS.

Willie Dean Smith  
Principal Pace School  
Pace, MS.

Jessie Pace  
Retired Post Master  
Pace, MS.

Ella Taylor  
Choir Director  
Pace, MS.

**PROGRAMMATIC CHART — toward the actuation of comprehensive  
HUMAN DEVELOPMENT PROJECTS — on the local level**  
thirty six programs — nine structures — three dynamics — one project



A ECONOMIC DEVELOPMENT LOCAL PRODUCTIVITY —toward self sustenance	B HUMAN DEVELOPMENT LOCAL MOTIVITY —toward self confidence	C SOCIAL DEVELOPMENT LOCAL SOCIALITY —toward self reliance
Enabling— <b>COOPERATIVE AGRICULTURE</b> I 1 expanded cultivation 2 intensified production 3 water delivery 4 equipment pool	Reconstructing— <b>HUMAN LIVING ENVIRONMENTS</b> IV 13 domestic housing 14 public facilities 15 functional structures 16 community design	Creating— <b>PREVENTATIVE MORTALITY CARE</b> VII 25 intermediate sanitation 26 total nutrition 27 systematic immunization 28 primary treatment
Developing— <b>APPROPRIATE LIGHT INDUSTRY</b> II 5 cottage production 6 agro businesses 7 processing plants 8 ancillary industry	Catalyzing— <b>CORPORATE ACTION STRUCTURES</b> V 17 inclusive engagement 18 sustenance commons 19 local youth corps 20 community work-force	Establishing— <b>INCLUSIVE FUNCTIONAL EDUCATION</b> VIII 29 early learning 30 formal schooling 31 youth training 32 adult education
Initiating— <b>LOCAL COMMERCIAL SERVICES</b> III 9 common marketing 10 local merchandizing 11 systematic savings 12 lending channels	Recovering— <b>COMMUNITY IDENTITY SYSTEMS</b> VI 21 corporate self story 22 common symbol system 23 community rituals 24 local celebrations	Instituting— <b>LOCAL COMMUNITY WELFARE</b> IX 33 family development 34 women's advancement 35 pre-adult care 36 elderly engagement

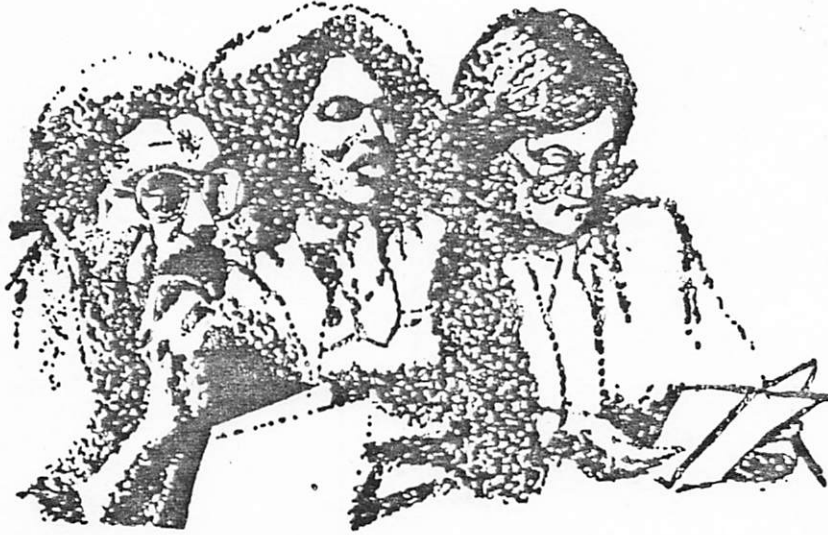

**PACE**  
**HUMAN DEVELOPMENT**  
**TRAINING SCHOOL**

<u>CONTENT</u>	<u>PAGE</u>
Table of Contents	1
Map of Pace	2
Pace Grid	3
Curriculum Design	4
Social Process Triangle	5
Programmatic Chart	6
Organizational Chart	7
E., C., & P., Principles	8
Profound Humanness Chart	9
Daily Time Design	10
Breakfast Procedures	11
Rituals	12
Participant Services	13
HDTS Facilities	14

# DELTA PACE

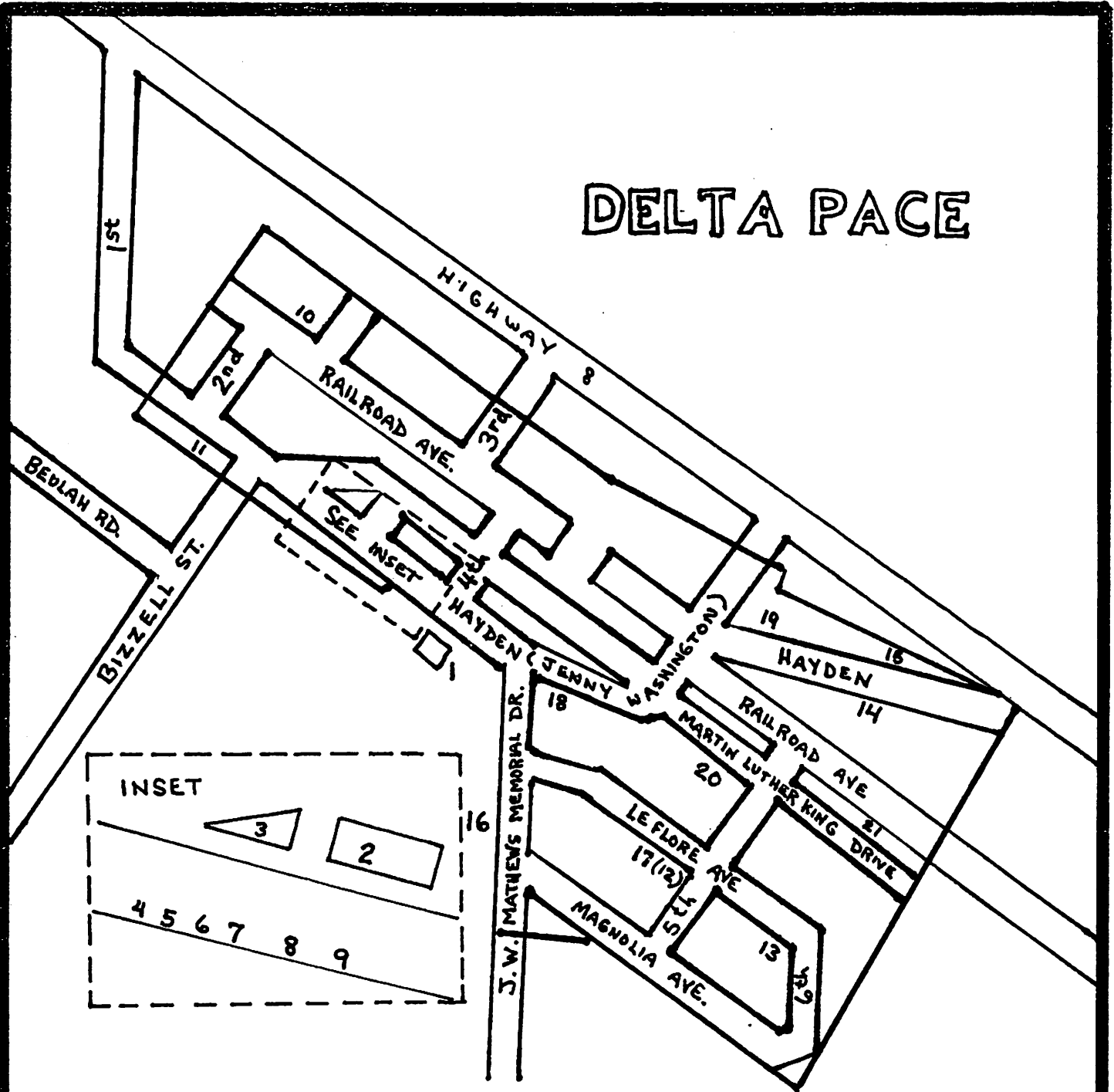

- |                            |   |                            |
|----------------------------|---|----------------------------|
| 1) ICA Office              | 8) Laundromat                                     | 15) St. Peter's Rock       |
| 2) Town Hall               | 9) Old Town Hall, Youth Dance Hall (Public Phone) | 16) Pace Attendance Center |
| 3) Post Office             | 10) Baptist                                       | 17) Headstart Buildings    |
| 4) Lum's                   | 11) Methodist                                     | 18) Restaurant (Blue Bldg) |
| 5) New Industry (Mr. Food) | 12) Spangle Banner                                | 19) Baseball field         |
| 6) Commercial Building     | 13) Pace Miracle Revival Center                   | 20) Elbethal Church        |
| 7) Preschool               | 14) St. Peter's M.B.                              | 21) Wats Chapel Church     |

# PACE GRID

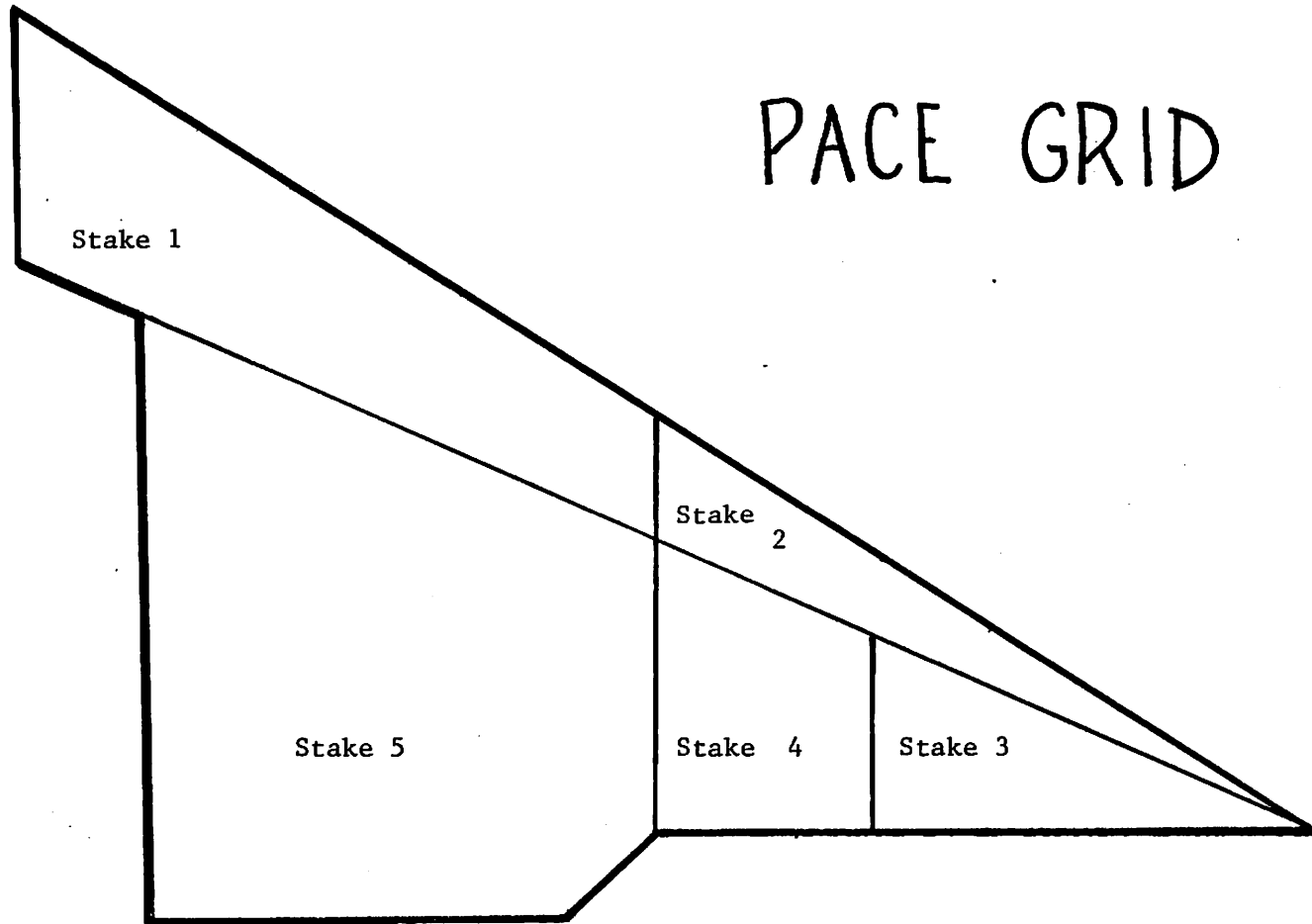



HUMAN DEVELOPMENT TRAINING SCHOOL CURRICULUM DESIGN

ECONOMIC DEVELOPMENT				SOCIAL DEVELOPMENT				CULTURAL DEVELOPMENT			
Week 1				Week 2				Week 3			
20th Century Perspectives			REFLECTION meal	UR Images			REFLECTION meal	Trends of the Future			REFLECTION
Economic	HERITAGE EXCURSION	WORK DAY		Social	URBAN EXCURSION	TOWN MEETING DAY		Cultural	ART EXCURSION	DOCUMENTATION	
Round Table				Round Table				Round Table			
Cycle				Cycle				Cycle			
Leadership Methods	Imaginal Leadership Lab	celebr.	Workshop Methods	Community Forum Lab	celebr.	Motivation Methods	Profound Humanness Lab	celebr.			

7

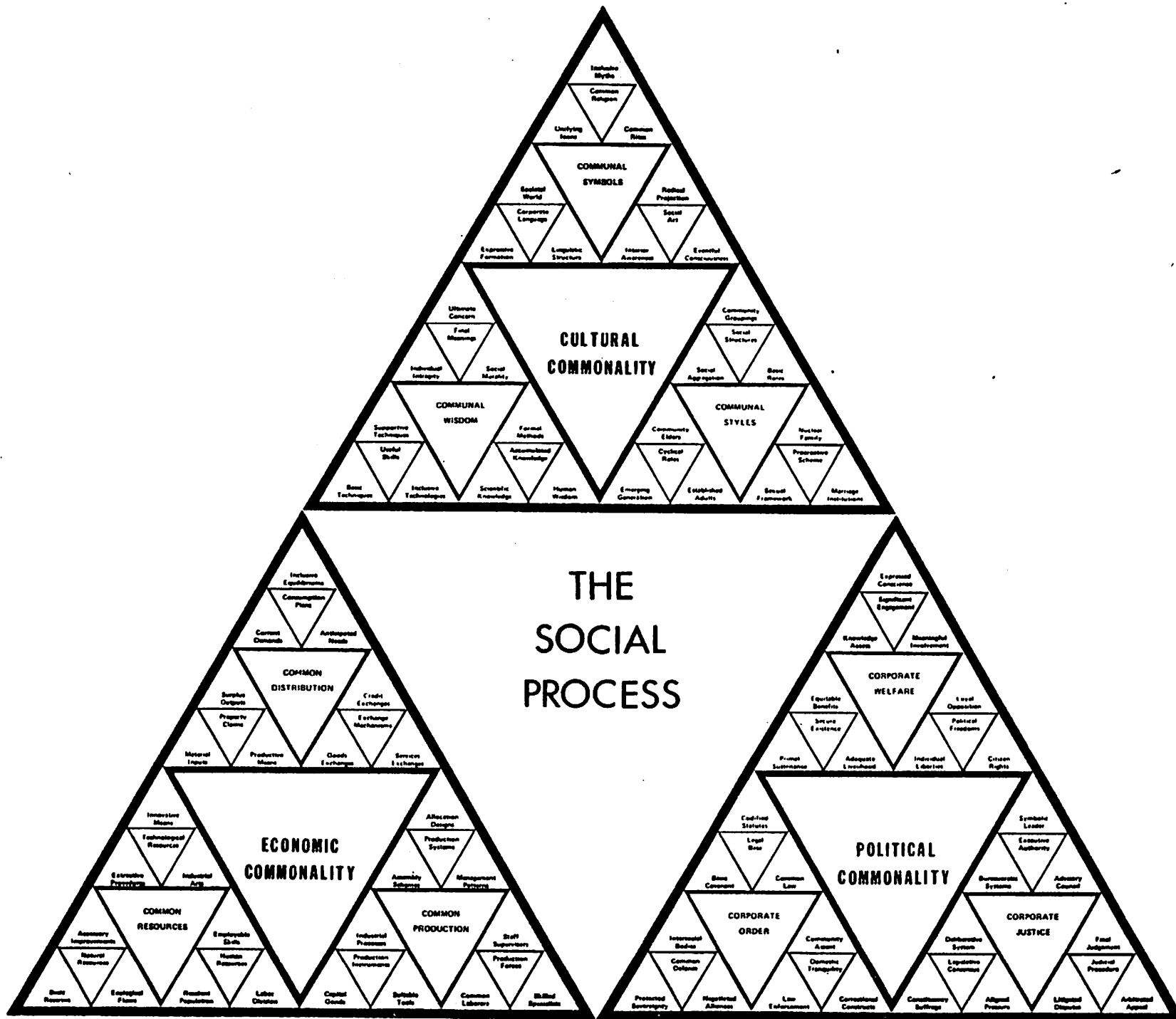

# PROGRAMMATIC CHART



Toward the Actuation of Comprehensive Human Development Projects on the Local Level

thirty six programs – nine structures – three dynamics – one project

<p style="text-align: center;">A ECONOMIC DEVELOPMENT LOCAL PRODUCTIVITY toward self sustenance</p>	<p style="text-align: center;">B HUMAN DEVELOPMENT LOCAL MOTIVITY -toward self-confidence</p>	<p style="text-align: center;">C SOCIAL DEVELOPMENT LOCAL SOCIALITY -toward self-reliance</p>																								
<p>Enabling local—</p> <p style="text-align: center;"><b>COOPERATIVE AGRICULTURE</b></p> <table border="1"> <tr><td>1</td><td>expanded cultivation</td></tr> <tr><td>2</td><td>intensified production</td></tr> <tr><td>3</td><td>water delivery</td></tr> <tr><td>4</td><td>equipment pool</td></tr> </table>	1	expanded cultivation	2	intensified production	3	water delivery	4	equipment pool	<p>Reconstructing local—</p> <p style="text-align: center;"><b>LIVING ENVIRONMENT</b></p> <table border="1"> <tr><td>13</td><td>domestic housing</td></tr> <tr><td>14</td><td>public facilities</td></tr> <tr><td>15</td><td>village design</td></tr> <tr><td>16</td><td>essential services</td></tr> </table>	13	domestic housing	14	public facilities	15	village design	16	essential services	<p>Creating local—</p> <p style="text-align: center;"><b>PREVENTIVE CARE</b></p> <table border="1"> <tr><td>25</td><td>intermediate sanitation</td></tr> <tr><td>26</td><td>total nutrition</td></tr> <tr><td>27</td><td>systematic immunization</td></tr> <tr><td>28</td><td>primary treatment</td></tr> </table>	25	intermediate sanitation	26	total nutrition	27	systematic immunization	28	primary treatment
1	expanded cultivation																									
2	intensified production																									
3	water delivery																									
4	equipment pool																									
13	domestic housing																									
14	public facilities																									
15	village design																									
16	essential services																									
25	intermediate sanitation																									
26	total nutrition																									
27	systematic immunization																									
28	primary treatment																									
<p>Developing local—</p> <p style="text-align: center;"><b>APPROPRIATE INDUSTRY</b></p> <table border="1"> <tr><td>5</td><td>cottage production</td></tr> <tr><td>6</td><td>agro-business</td></tr> <tr><td>7</td><td>processing plants</td></tr> <tr><td>8</td><td>ancillary industry</td></tr> </table>	5	cottage production	6	agro-business	7	processing plants	8	ancillary industry	<p>Catalyzing local—</p> <p style="text-align: center;"><b>CORPORATE PATTERNS</b></p> <table border="1"> <tr><td>17</td><td>total engagement</td></tr> <tr><td>18</td><td>community commons</td></tr> <tr><td>19</td><td>consensus assemblies</td></tr> <tr><td>20</td><td>corporate workdays</td></tr> </table>	17	total engagement	18	community commons	19	consensus assemblies	20	corporate workdays	<p>Establishing local—</p> <p style="text-align: center;"><b>FUNCTIONAL EDUCATION</b></p> <table border="1"> <tr><td>29</td><td>early learning</td></tr> <tr><td>30</td><td>formal schooling</td></tr> <tr><td>31</td><td>youth training</td></tr> <tr><td>32</td><td>adult education</td></tr> </table>	29	early learning	30	formal schooling	31	youth training	32	adult education
5	cottage production																									
6	agro-business																									
7	processing plants																									
8	ancillary industry																									
17	total engagement																									
18	community commons																									
19	consensus assemblies																									
20	corporate workdays																									
29	early learning																									
30	formal schooling																									
31	youth training																									
32	adult education																									
<p>Initiating local—</p> <p style="text-align: center;"><b>COMMERCIAL SERVICES</b></p> <table border="1"> <tr><td>9</td><td>common marketing</td></tr> <tr><td>10</td><td>local merchandising</td></tr> <tr><td>11</td><td>savings &amp; loans</td></tr> <tr><td>12</td><td>basic transport</td></tr> </table>	9	common marketing	10	local merchandising	11	savings & loans	12	basic transport	<p>Recovering local—</p> <p style="text-align: center;"><b>IDENTITY SYSTEMS</b></p> <table border="1"> <tr><td>21</td><td>community self-story</td></tr> <tr><td>22</td><td>symbol systems</td></tr> <tr><td>23</td><td>corporate rituals</td></tr> <tr><td>24</td><td>village celebrations</td></tr> </table>	21	community self-story	22	symbol systems	23	corporate rituals	24	village celebrations	<p>Instituting local—</p> <p style="text-align: center;"><b>COMMUNITY WELFARE</b></p> <table border="1"> <tr><td>33</td><td>family development</td></tr> <tr><td>34</td><td>women's advancement</td></tr> <tr><td>35</td><td>youth task-force</td></tr> <tr><td>36</td><td>elderly engagement</td></tr> </table>	33	family development	34	women's advancement	35	youth task-force	36	elderly engagement
9	common marketing																									
10	local merchandising																									
11	savings & loans																									
12	basic transport																									
21	community self-story																									
22	symbol systems																									
23	corporate rituals																									
24	village celebrations																									
33	family development																									
34	women's advancement																									
35	youth task-force																									
36	elderly engagement																									



# ORGANIZATIONAL CHART

Toward the Actuation of Comprehensive Human Development Projects on the Local Level

I. The Assembly - II. The Secretariat - III. The Commissions - IV. The Guild Network - V. The Stake System

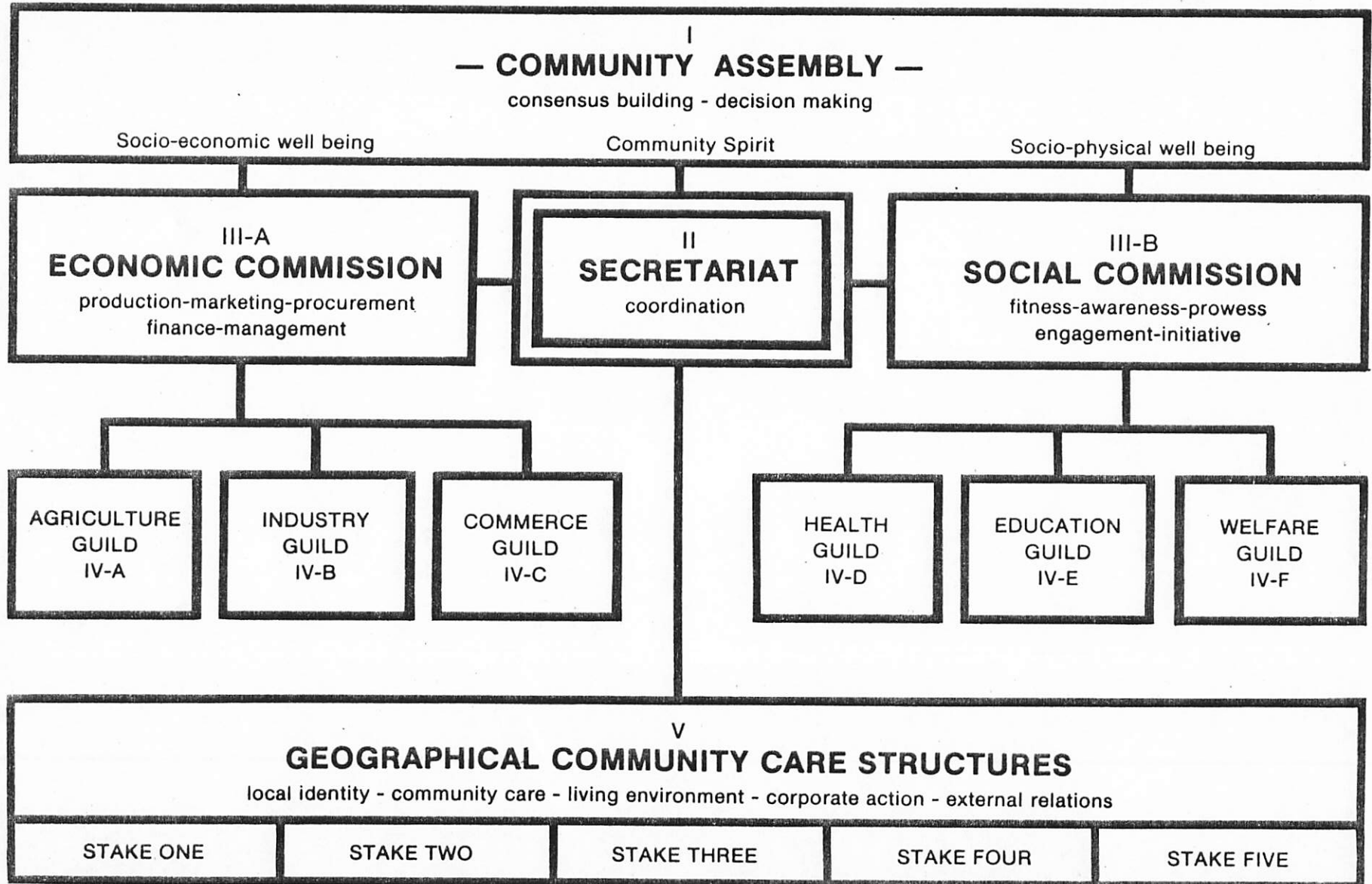

ECONOMIC, CULTURAL AND SOCIAL PRINCIPLES

Global Research Centrum: Chicago (working draft)

ECONOMIC PRINCIPLES

1. Autonomous Unit
2. Monetary Input
3. Monetary Retention
4. Monetary Circulation
5. Global Relatedness

CULTURAL PRINCIPLES

1. Rapid expansion of consciousness
2. Expand interior space
3. Extend interior time
4. Diversify human relationships
5. Expansion of corporate engagement

SOCIAL PRINCIPLES

1. Delimited Geography
2. All Problems
3. All People
4. Depth Issue
5. Symbol is Key

# THE QUALITIES of PROFOUND HUMANNESS



*"Civilization is the continual discovery of profound humanity."*

## INTERNAL STATES of BEING

### EXTERNAL MANIFESTATIONS

I	II	III	IV
<p><b>EVENT</b></p> <p>unexpected intrusion altered situation immediate response decisional appropriation</p>	<p><b>ACTION</b></p> <p>appropriate deeds representational engagement decisional victory manifest intentionality</p>	<p><b>DECLARATION</b></p> <p>continual exposure visible sign constant interpretation public accountability</p>	<p><b>INTEGRITY</b></p> <p>audacious creation destinal resolve incarnate freedom societal transvaluation</p>
<p><b>MYSTERY</b></p> <p>mundane transparentization disclosed unknownness nameless fear dreadful fascination</p>	<p><b>TOTALITY</b></p> <p>historical responsibility encompassing unity limitless commitment infinitesimal detail</p>	<p><b>CREATIVITY</b></p> <p>universal relativity historical engagement decisional impact sociological creativity</p>	<p><b>CARE</b></p> <p>overwhelming reality empassioned detachment universal service perpetual expenditure</p>
<p><b>CONSCIOUSNESS</b></p> <p>illuminated relationship impactful imagery paradigmatic insight transrational interpretation</p>	<p><b>CORPORATENESS</b></p> <p>focused power covenantal collegiality profound fellowhood decisional obedience</p>	<p><b>PRESENCE</b></p> <p>inescapable selfhood enigmatic archetype internalized affirmation transparent signification</p>	<p><b>EFFULGENCE</b></p> <p>endless affirmation unlimited power paradoxical abundance restless tranquility</p>

PACE  
HDTS

DAILY TIME DESIGN

June 1 - 23, 1980

	DISCIPLINE	TIME	EVENT
MORNING	WAKEUP	6:00 a.m.	Wakeup rite, rising and preparing for the day
	BREAKFAST	6:30 a.m.	Opening Ritual Breakfast/Collegium
		8:00 a.m.	Individual/Space Care
	MODULE/ LABORATORY	8:30 a.m.	Contextual Talk and Interchange
		9:30 a.m.	Snack
		9:30 a.m.	Field Session/Lab Workshop
		11:30 a.m.	Interlude
AFTERNOON	DINNER/ ROUNDTABLE	12:00 noon	Dinner Conversation/Study
		1:30 p.m.	Break
	MODULE/ LABORATORY	3:30 p.m.	Field Session/Lab Workshop
		6:00 p.m.	Preparation for dinner
EVENING	SUPPER	7:00 p.m.	Leadership Methods Dinner/Methods Use/ Evaluation
		8:30 p.m.	Informal Conversation
	PHYSICAL RESTORATION	10:00 p.m.	Sleep

OPENING

Gathering around the table set for breakfast, begin the DAILY RITUAL.  
"Let the community stand."

SINGING: "Let us turn to page \_\_\_\_\_ and sing \_\_\_\_\_"

THE DAILY RITUAL

ACCOUNTABILITY: "Let the Pace Human Development Training School stand accountable for its presence at breakfast by Teams. Let the Team Leaders stand. Team One." (Team, 2, 3, 4, etc.)

Team Leader: "Team \_\_\_\_\_ assumes responsibility for the care of its members and reports \_\_\_\_\_ on special assignment, \_\_\_\_\_ is ill and checked on, \_\_\_\_\_ is absent and checked on. All others are present." (When doing symbolic accountability, Team Leaders say: "Team \_\_\_\_\_ reports that all are present or accounted for.")

ABSOLUTION:

MEAL RITE

"Repeat after me: "At the edge of history  
The future is blowing wildly in our faces  
Sometimes brightening the air  
And sometimes blinding us."

(ALL ARE SEATED )

"Let us eat this meal on behalf of \_\_\_\_\_

(someone or group who is doing something relative to the day's work )

"Let us feast." (FOOD IS SERVED)

CONVER-  
SATION

- Read the quote from the Journal (once or more )
1. What word, phrase caught your attention?
  2. In what situation might someone say this? (and/or ) What real life situation does this quote bring to mind?
  3. What is the truth about life this passage intends to communicate?
  4. Under what circumstances would you want to share this? with whom?

Ask for news.

1. What recent news event altered your understanding of the world?
2. Which one should we talk about? (May need to get more information.)
3. What is the significance of this in the globe? for us?

COLLEGIUM

"Now let's turn to Collegium and sing \_\_\_\_\_."

SEND-OUT

ANNOUNCEMENTS (Including agenda for the day )

"I send you out to \_\_\_\_\_. THESE ARE THE TIMES."

Community: WE ARE THE PEOPLE."

H  
O  
S  
T

C  
O  
N  
V.  
L  
D  
R.

H  
O  
S  
T



# The Daily Ritual

(Let the Community stand and sing first two verses of the song, "Creation")

## CREATION

### ENTRY (Verses 1 and 2)

A time to set forth a new demand,  
A time to look into the past,  
For without "what has been," there is no "yet to be,"  
Nothing that we do then could last.

#### Refrain

We stand beyond our life and see,  
We stand beyond our death and really see,  
What's required of those who give their death to history;  
And it is now that we must do  
What other ones have always longed to see,  
To discover what's required  
To set all people free.

No more must we live with poverty,  
No more in strife and disarray,  
For when Those Who Care create all the earth,  
That shall be the new day.

### EXIT (Verses 3 and 4)

In those who choose to be all there is  
Pain and misery are past,  
Transformed because they bring forth human life;  
New life never comes but through a death.

#### Refrain

The global task now has claimed our lives,  
Who knows where our bodies they shall find?  
But with us, anew, now the mystery appears,  
The meaning of the life of all Mankind.

#### Refrain

**Leader:** Let us stand before life as those who care  
for the world.

**Community:** Be it so.

**ACT I:** **L:** Life is never the way we want it.  
**C:** We refuse to accept its promise.  
**L:** Nevertheless we are free to live.  
**C:** Be it so.

(Let the community be seated)

### Reading for the Day

(Let the community stand)

**ACT II:** **L:** This is the day we have on our hands.  
**C:** We give thanks for the life we have.  
**L:** This is our decision.  
**C:** Be it so.

**L:** Let all the joy mingle in my last song.

**Community Left:** The joy that makes the earth flow  
over in riotous excess.

**Community Right:** The joy that sets the twin brothers, life  
and death dancing,

**Community Left:** The joy that sweeps in the tempest,  
waking all life with laughter,

**Community Right:** The joy that throws everything it has  
upon the dust.

(Let the community be seated)

### Address for the Day

(Let the community stand)

**ACT III:** **L:** We stand before the world and its need.  
**C:** Let us give ourselves to the task.  
**L:** It is to build the Earth.  
**C:** Be it so.

**L:** Let me not pray to be sheltered from dangers,  
**C:** But to be fearless in facing them.

**L:** Let me not beg for the stilling of my pain,  
**C:** But for the heart to conquer it.

**L:** Let me not look for allies in life's battlefield,  
**C:** But to my own strength.

**L:** Let me not crave, in anxious fear to be saved,  
**C:** But hope for the patience to win my freedom.

**Leader:** Let us go forth to enact our care for the world.

**Community:** Be it so.

(Let the community sing last two  
verses of the song, "Creation")

MONDAY

We can neither applaud nor tolerate irresponsible and wholly selfish individual development. Freedom without commitment is aimless and self-destructive. Here is a tension of opposites--to instill both a vigorous sense of individuality and at the same time a sense of shared purpose with their fellows. The one I respect is the one who has humbly placed himself at the service of a vision greater than himself, but who is able to give himself to a greater good because he has first achieved a mature individuality.

TUESDAY

Freedom then, is not the absence of any outside control, it is the acceptance of limitations. His path can never be as free as that of an airborne bird. He must pick his way painfully through a veritable jungle of alternatives, few of which are satisfactory; none of which is perfect. Man can never be the unconditional master of himself because he neither has complete control of himself, nor of his environment. He is at the mercy of dreams, hopes, fears, and lusts. So that self-will which poses as freedom will only result in a man putting himself under the heel of some subtle tyranny more frightening than any of those from which he fondly thinks he has freed himself.

WEDNESDAY

Experience has taught me that it is never enough to struggle against specific evils; one must also try to create an environment which is hospitable to the growth of the corresponding virtues. All societies are dynamic constantly in a state of flux, so that the passing of time can transform today's virtue into tomorrow's vice. Hence, the battle for justice is never won once and for all; the same battle has to be fought over and over again.

THURSDAY

You will, from time to time, be disillusioned and even hurt when you are let down; when your trust in another human being is repaid by treachery. But it is still better to give another human being the opportunity to rise to your highest expectations of him than to make it a policy to assume the worst in order that you may never be disappointed. Better by far to know both the joy and pain of honest human encounter than to construct a shell which may make you impervious to hurt but also keeps out that searching love.

FRIDAY

At all costs have the courage to fail. We pay a heavy price for our fear of failure. It hinders our growth and narrows the range of our achievements. The learning process will either stop or be restricted within narrow limits unless you are prepared to go on risking failure by trying new things, putting your trust in people who prove to be unknown quantities and exploring uncharted ways that may turn out to be dead ends or else open up new vistas of service and satisfaction.

SATURDAY

It is one of those obvious and easily ignored lessons of nature which applies equally to human society--that birth is always conquering death; that out of decay there springs renewal. The golden age about which we all dream and for which some of us strive is not a static state of bliss where all human problems will be resolved and mankind will live happily ever after. The golden age never dawns and yet paradoxically is always dawning when individuals are predictors and agents of renewal and bearers of it.

BREAKFAST

(Repeat after me)

- At the edge of history
- The Future is blowing wildly in our faces
- Sometimes brightening the air
- And sometimes blinding us.

DINNER

(Repeat after me)

- The Task before us now
- If we would not perish
- Is to shake off our ancient prejudices
- And to build the earth.

SUPPER

(Repeat after me)

- Action will remove the doubt
- That theory cannot solve.

CLOSING

Leader: These are the times,

Community: We are the people.

(Repeat)

- TELEPHONE** There is one public phone located opposite the City Hall. Phone messages will be taken at the school office (601-723-6253) and posted in the lounge. The office phone is not available for outgoing personal calls.
- MAIL** Incoming mail for HDTs participants will be delivered to the lounge. Outgoing mail may be put in the drop box in front of the Post Office in downtown Pace. The mail is picked up at the Post Office at 4:00 p.m. The Post Office hours are 7:30 a.m. to 4:30 p.m. on weekdays and 7:30 a.m. to 11:30 a.m. on Saturdays. The mailing address for the HDTs is : c/o I.C.A., P.O. Box 269, Pace, MS 38764.
- HEALTH** For first aid or health services information contact Joan Priest. The nearest hospital is Bolivar County Hospital in Cleveland. The phone number of the hospital is 1-843-0061.
- ACCOMODATIONS** Men's and women's dormitories are located in the Bolivar County Headstart Center on LeFlore Ave. Community residents are hosting women participants for bathing. (Please see separate hosting sheet for details.) We request that women honor the bathing times arranged with their host families. Men's showers are available in the men's bathroom in the school.
- LAUNDRY** The Delta Pace Laundromat is located in downtown Pace. The hours are 7 a.m. to 10 p.m. including Sundays. The cost is 50¢ per washer and 25¢ per dryer.
- TRANSPORTATION** Transportation for program activities will be provided. There is no public transportation between Pace and surrounding communities. Emergency transportation should be arranged with Molly Shaw.
- SUNDAY OPPORTUNITIES** Sunday will be a time to relax and enjoy the sights of Mississippi. Group transportation by bus or car pool will be provided to nearby recreation in Cleveland or Rosedale.
- PARTICIPANT SERVICES COORDINATOR** The staff of the HDTs is available to assist you in any way they can. Joan Priest is the services coordinator for the school.

PACE HDTS

# FACILITIES

JUNE, 1980

## PACE ATTENDANCE CENTER

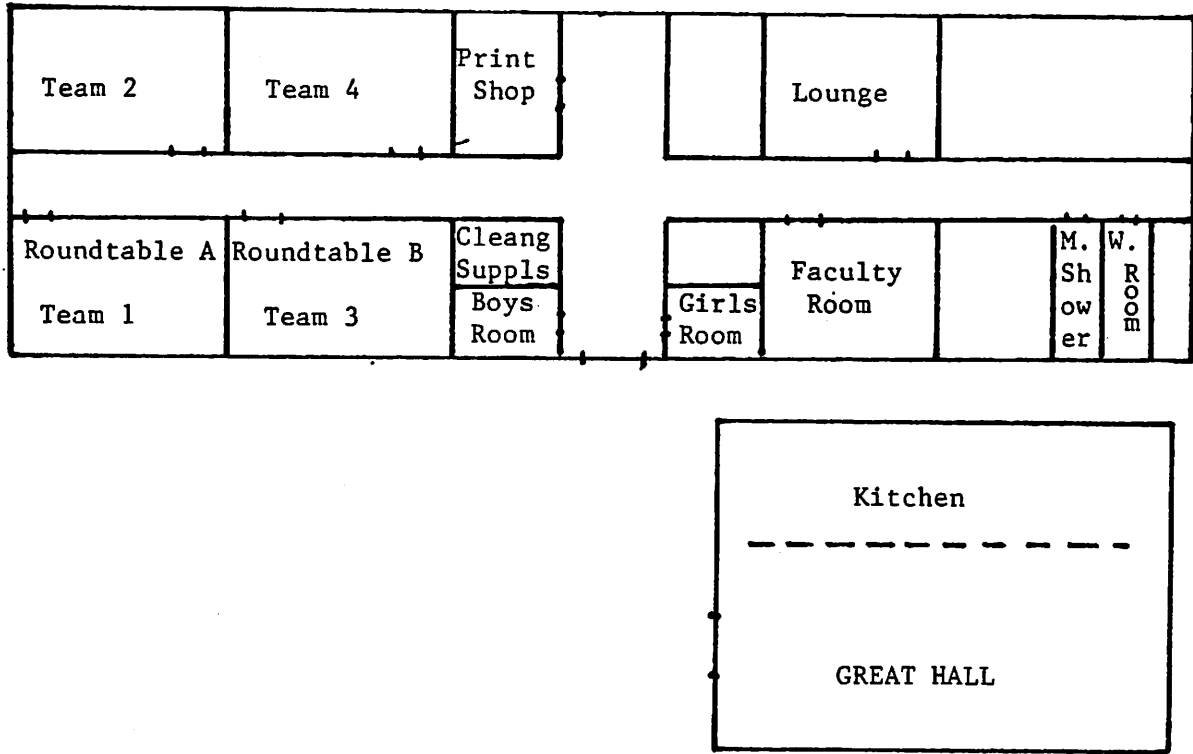

← to Mathews Memorial Dr.  
and Attendance Center

LEFLORE AVE.

Drive-  
way

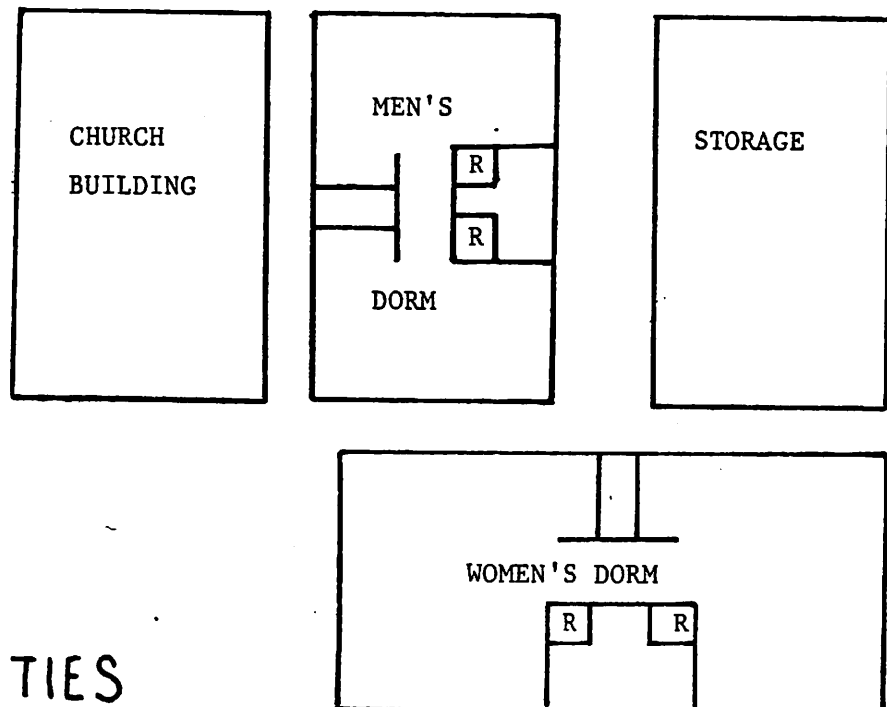

## RESIDENTIAL FACILITIES